



atlantic

AIRBUS A340-600 : ASSEMBLY INSTRUCTIONS

Canon

© Canon Inc. © P. Model K. Kiyonaga

CREATIVE PARK

<http://www.canon.com/c-park/>

Virgin Atlantic Airways : AIRBUS A340-600

Since it was founded twenty-three years ago, Virgin Atlantic Airways has become Britain's second largest airline serving the world's major cities. The Airbus A340-600 is the longest-range aircraft in the world, at 75.3 m. It also has a modified wing with an increased span of 63.4 m. The new A340-600 entered service with launch customer Virgin Atlantic in July 2002. The A340-600 is configured with 308 seats in the Virgin Atlantic three class layout.

The AIRBUS A340-600 features an overall length of 75.30m and is 17.3m high, with a wingspan of 63.45m. With a maximum take-off weight of 365 tons, it can cover distances of up to 13,900 km.

Front



Over look



Side



Underside



Completed Model (Total length)
(Total width)

About 626mm (Scale About 1:120)
About 528mm

Pattern

18 pages (No. of Parts: 303)

Assembly Instructions

16 pages

This model was designed for Papercraft and may differ from the original in some respects.

*Build the model by carefully reading the Assembly Instructions, in the parts sheet page order.

Assembly Process

Attach the parts in order.

A1~Q3 No. of Parts

You can choose to make either a grounded style (with wheels) or an in-flight style (without wheels) aircraft.

*Glue, scissors and other tools may be dangerous to young children so be sure to keep them out of the reach of young children.

Assembly Tip

- Small pieces will be easier to cut out if you fold along the lines first. Cut them out after you have folded them.
- Before gluing each piece, be sure to compare its shape to the corresponding surface to ensure it is the correct piece.

Folds & Marks

Trace along the folds with a ruler and a used pen (no ink) to get a sharper, easier fold.

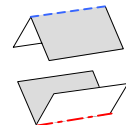

Mountain fold line

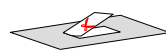

Cut out



Assemble in the direction indicated by the arrow

Glue spot

Each glue spot has a mark indicating how to attach it.

- Glue to the rear of the other part
- ▲ Glue within the same part
- Glue the rear of this part

Tools

Scissors, glue (We recommend craft glue), ruler, tweezer, stencil pen, used pen (no ink).

1.

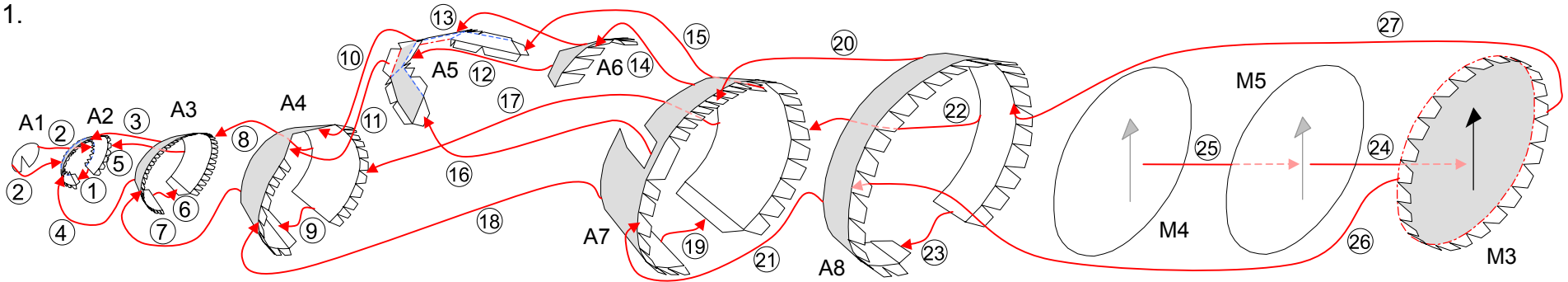

2. Choose whether to make a grounded model or in-flight model.

If making a grounded model

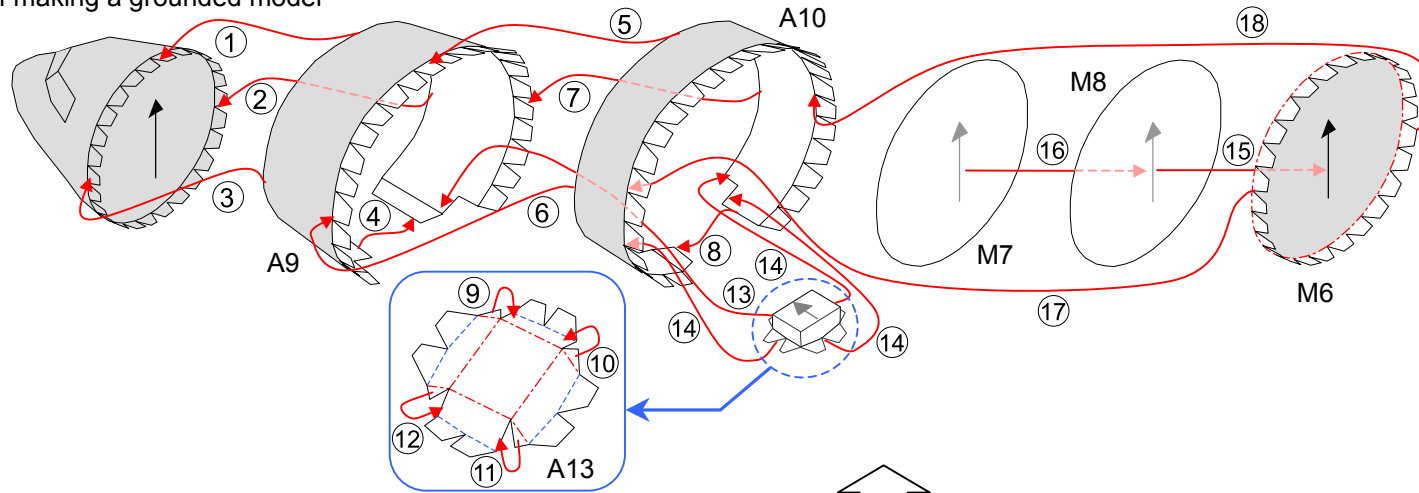

If making an in-flight model

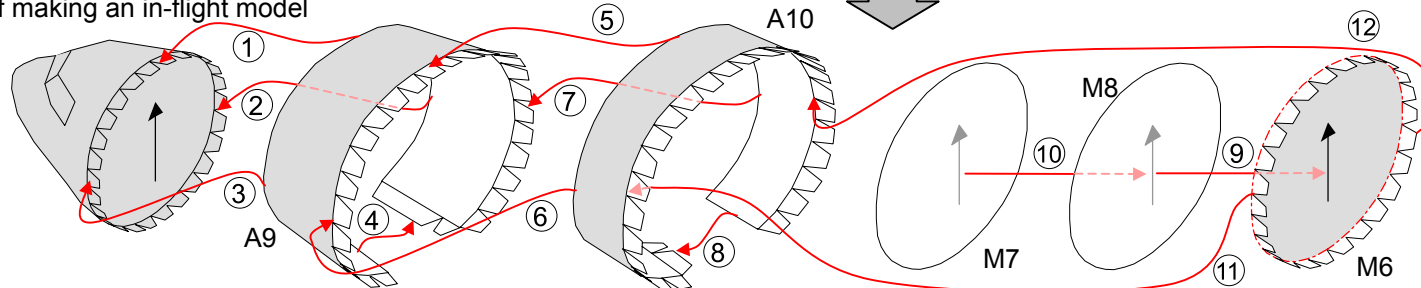

Cut out the parts indicated in red before use

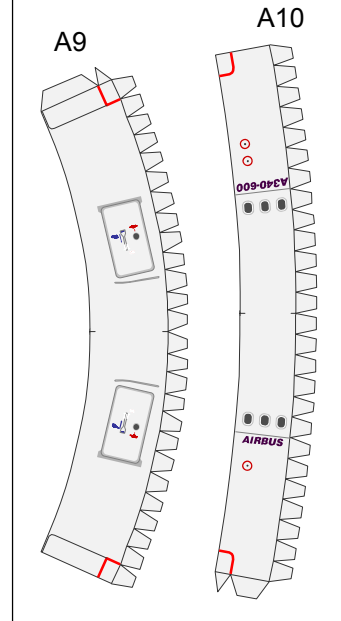

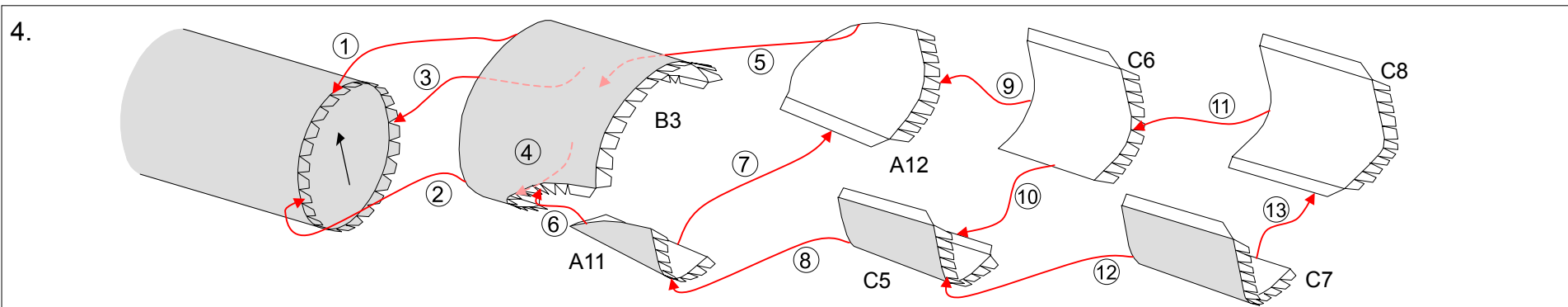
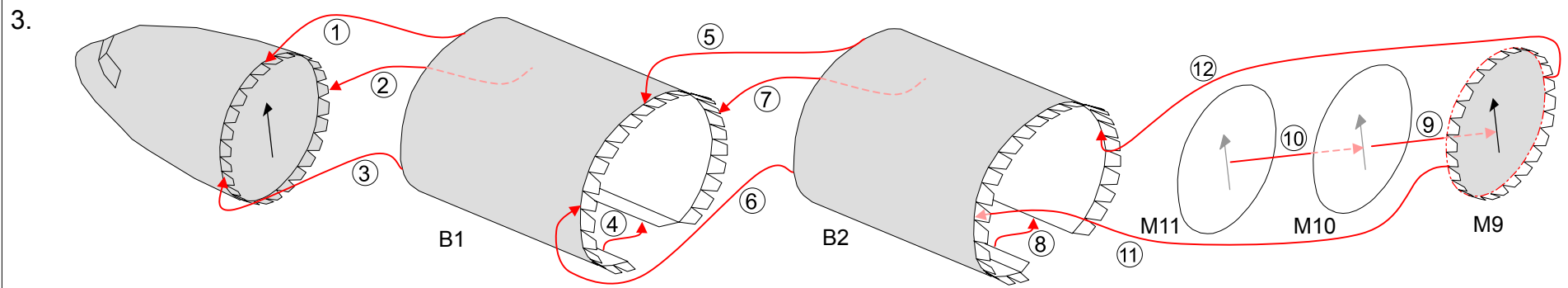

5. Choose whether to make a grounded model or in-flight model.

If making a grounded model

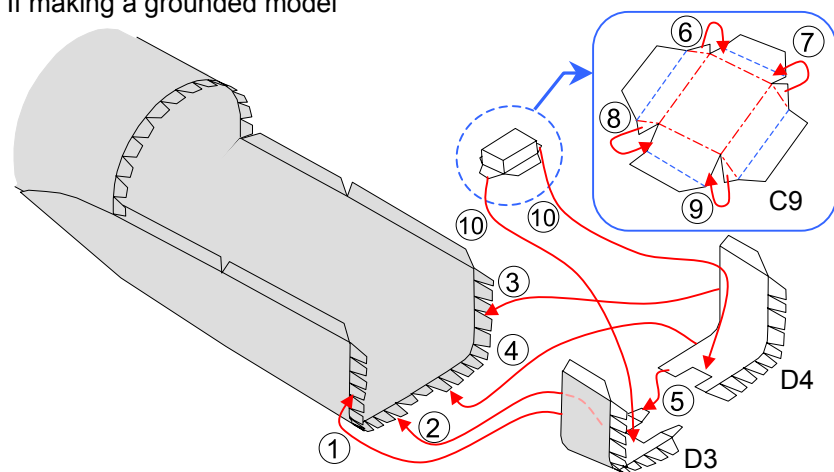

Cut out the parts indicated in red before use

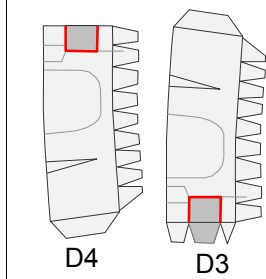

If making an in-flight model

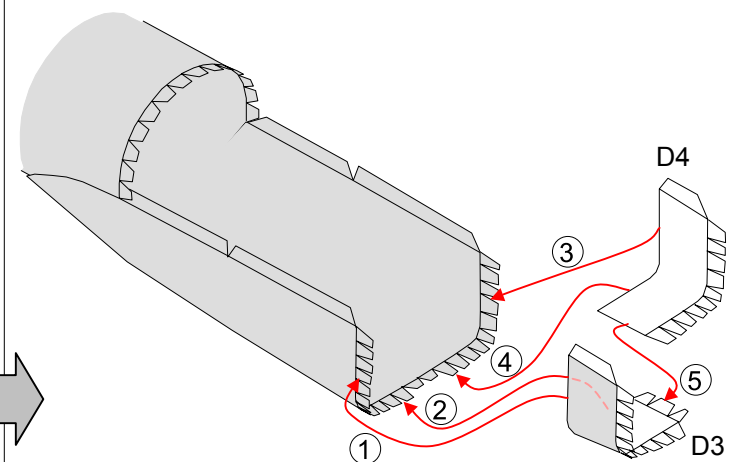

6.

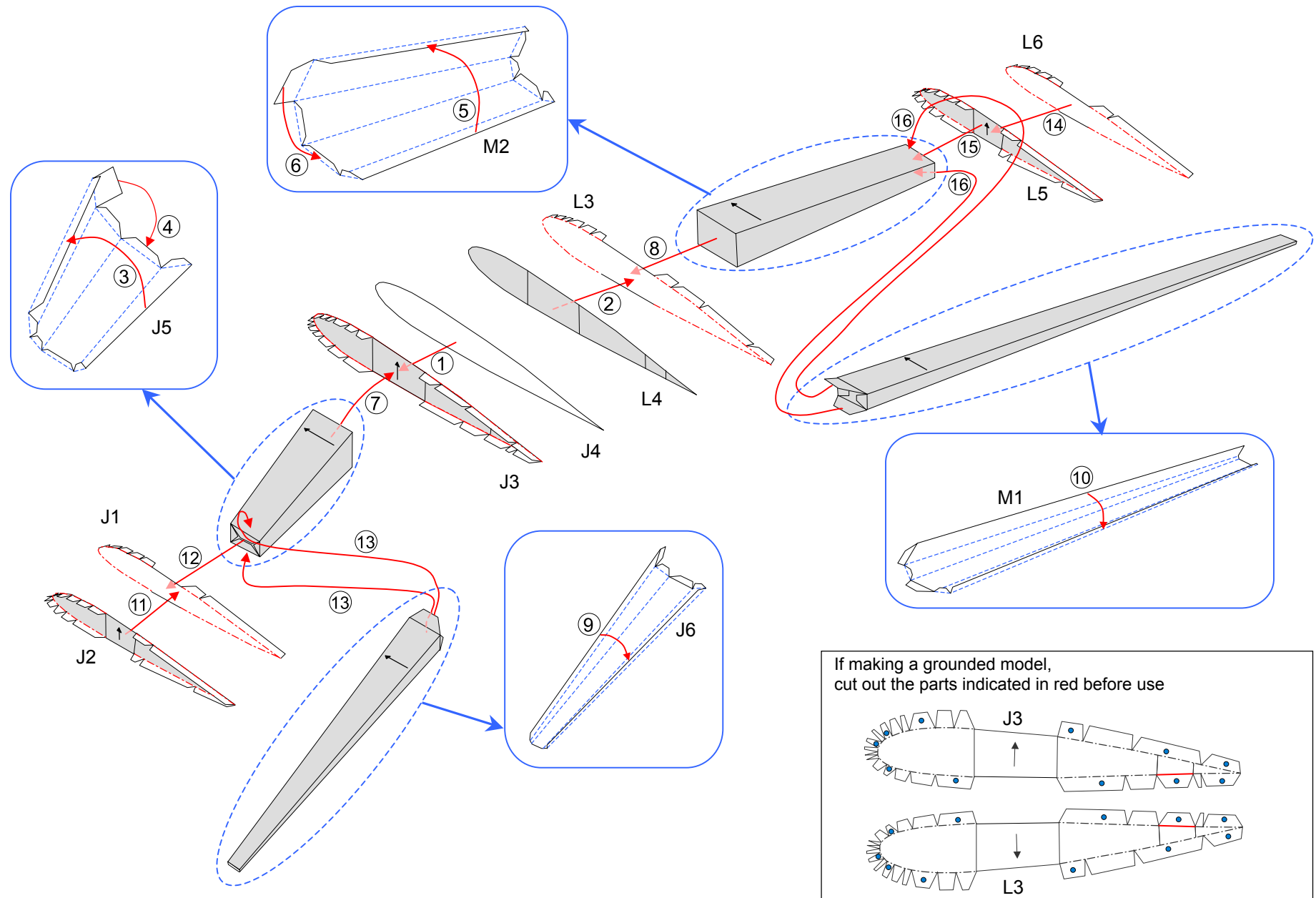

7.

If making a grounded model,
cut out the parts indicated in red before use

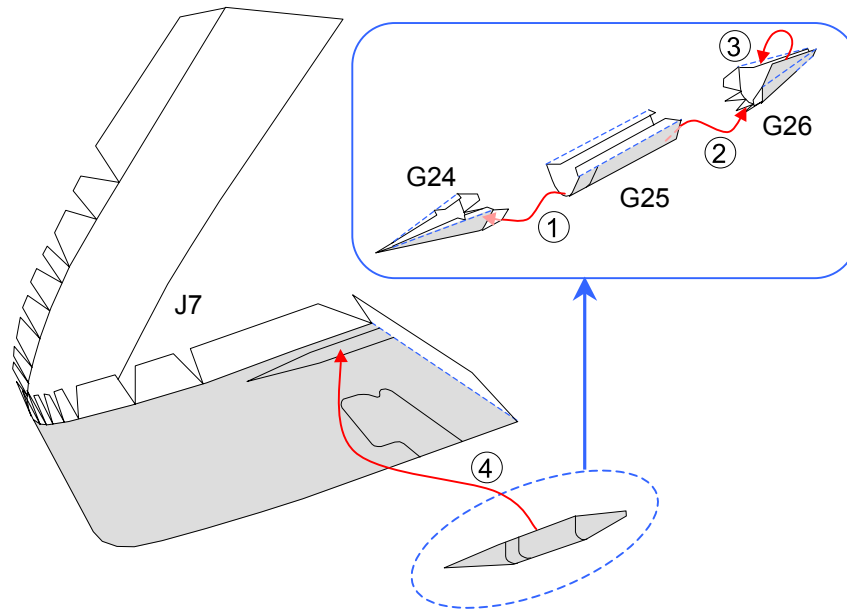
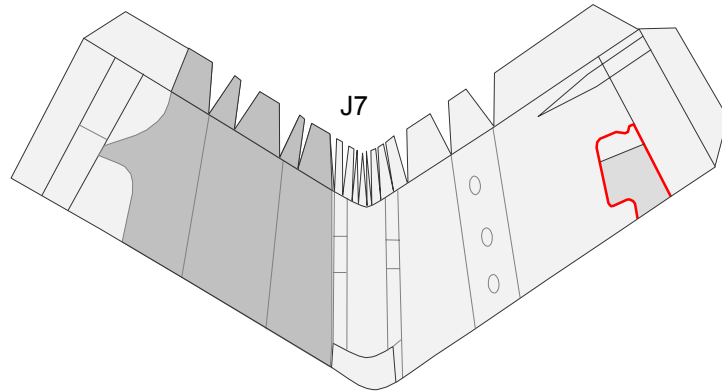

8.

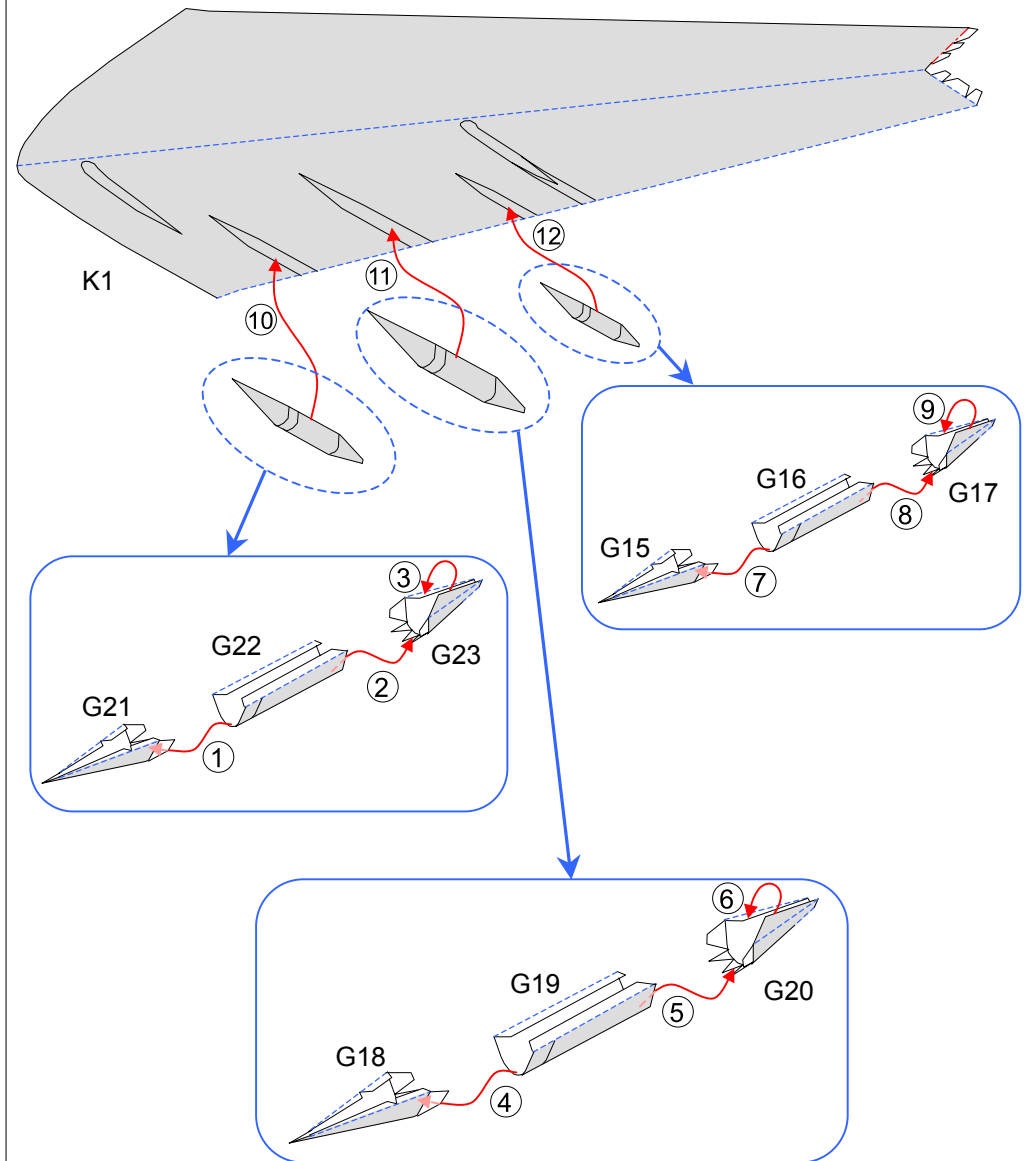

9.

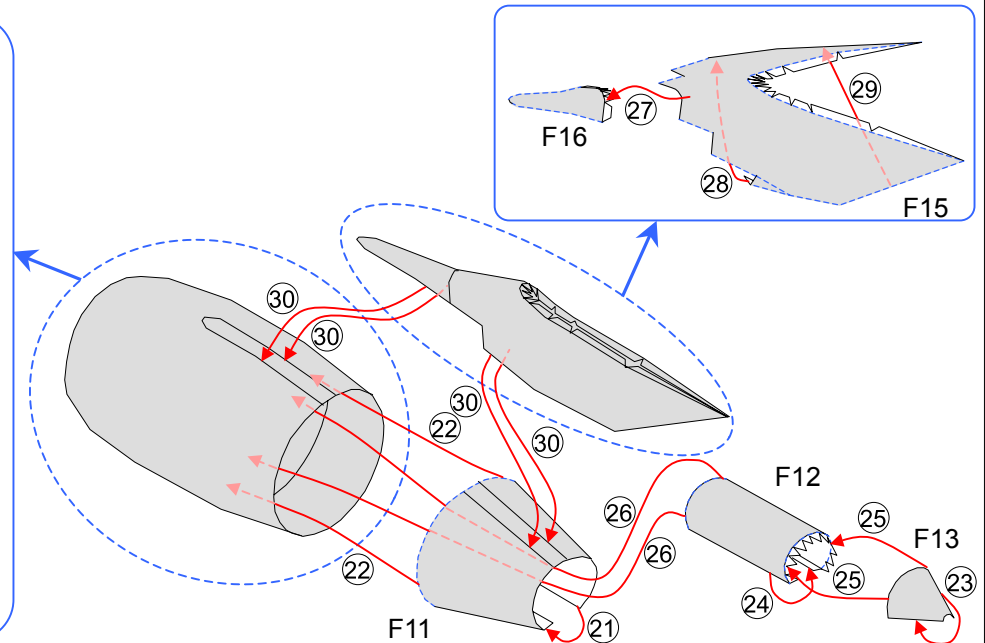
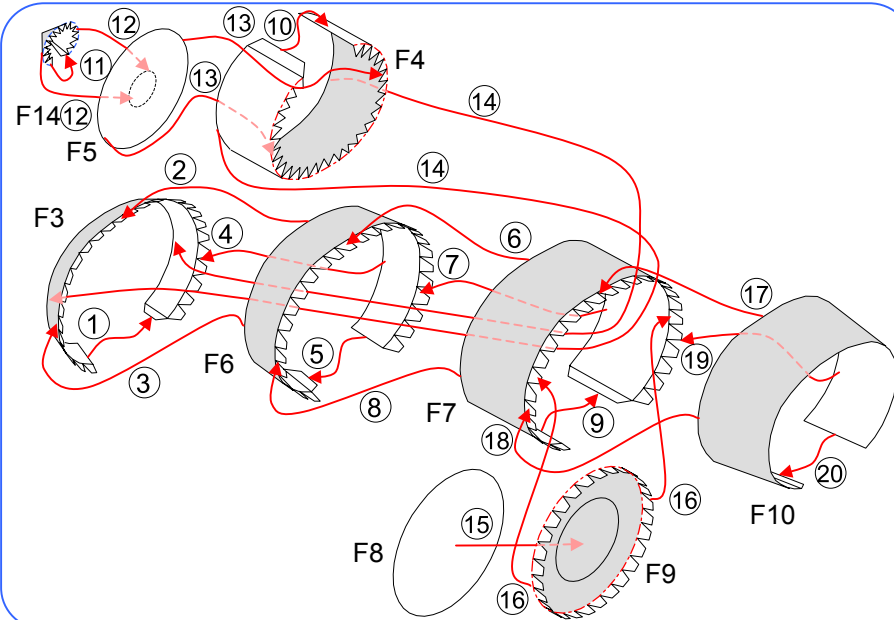

10.

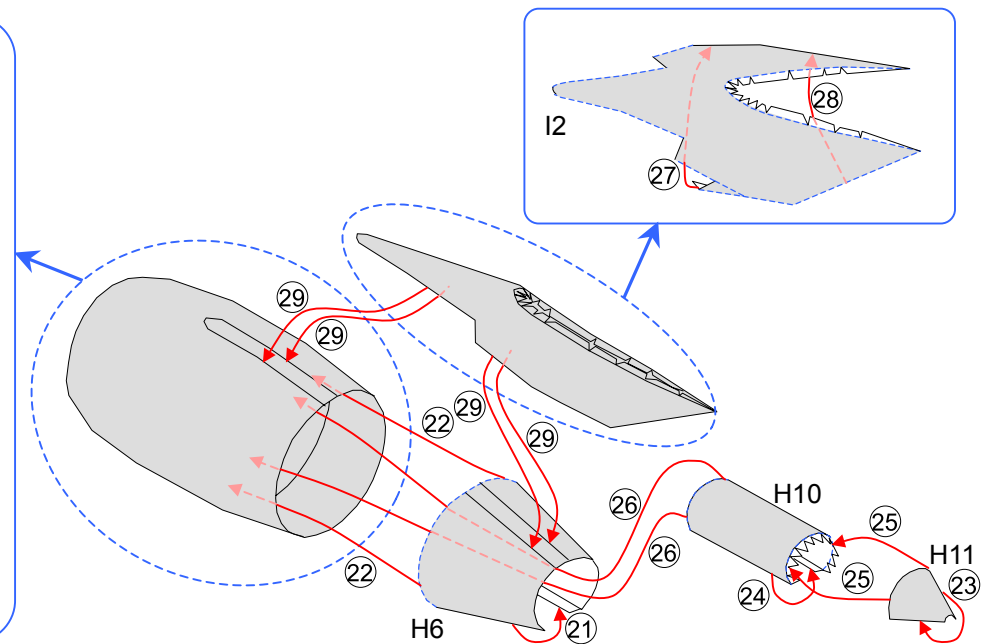
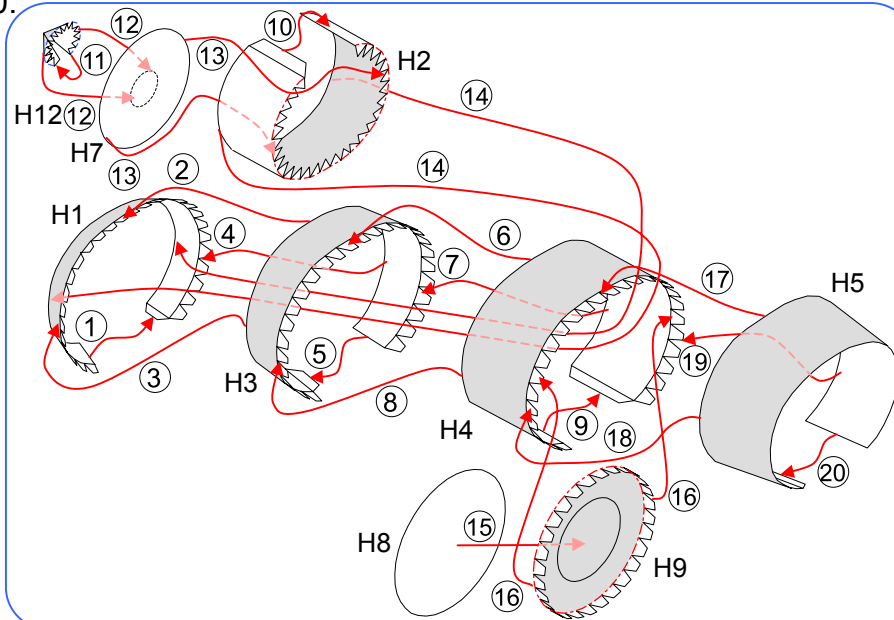

11.

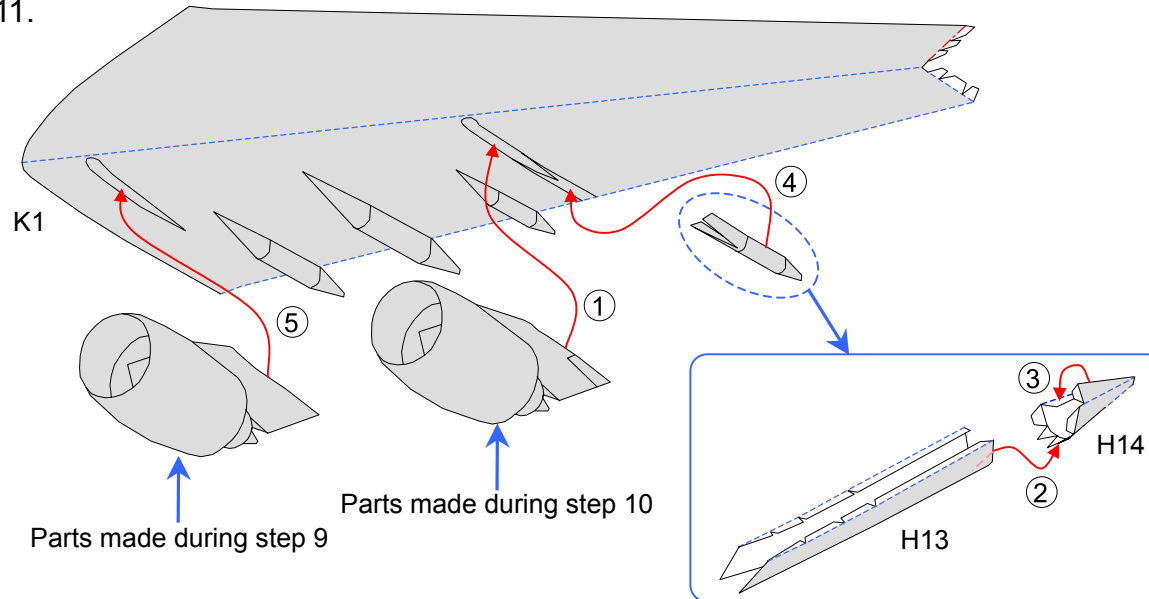

13.

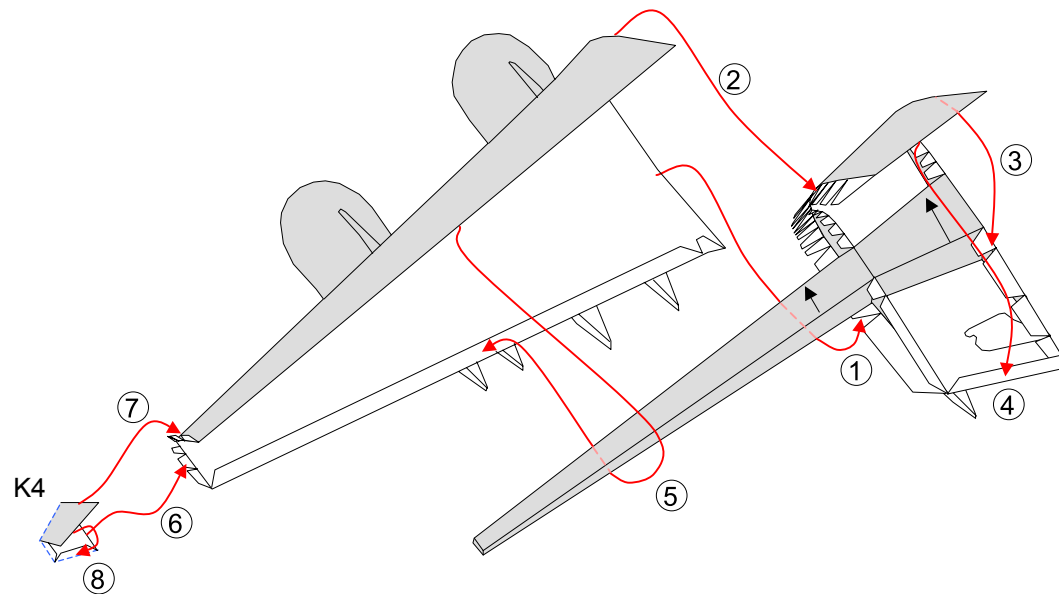

12.

If making a grounded model

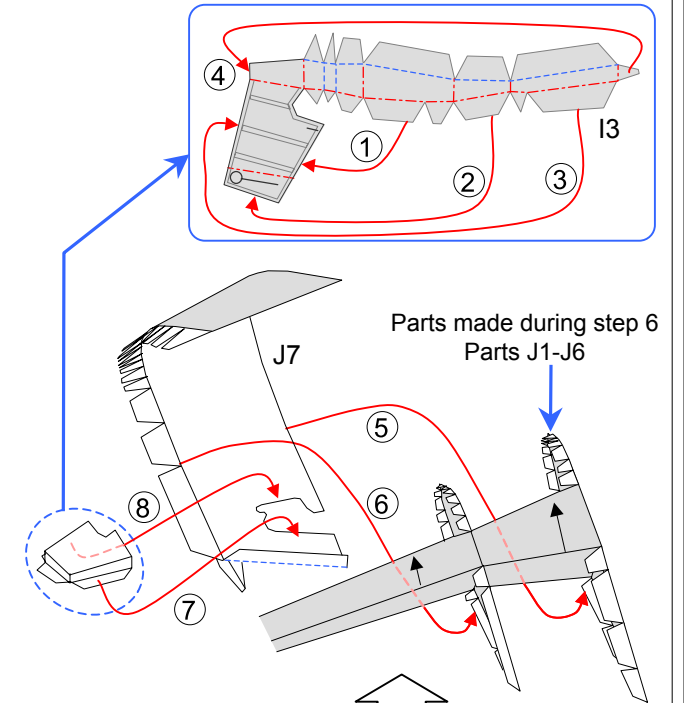

If making an in-flight model

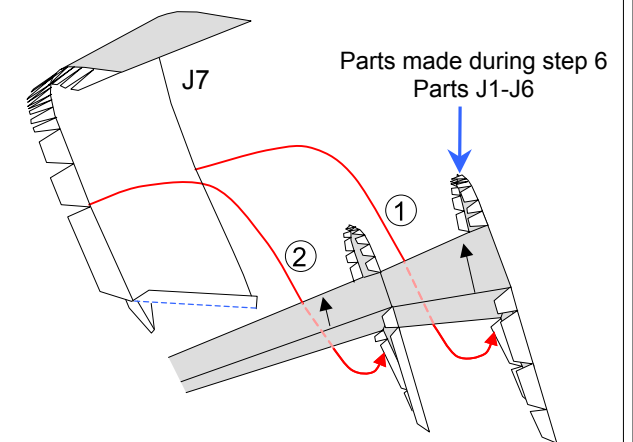

14.

If making a grounded model,
cut out the parts indicated in red before use

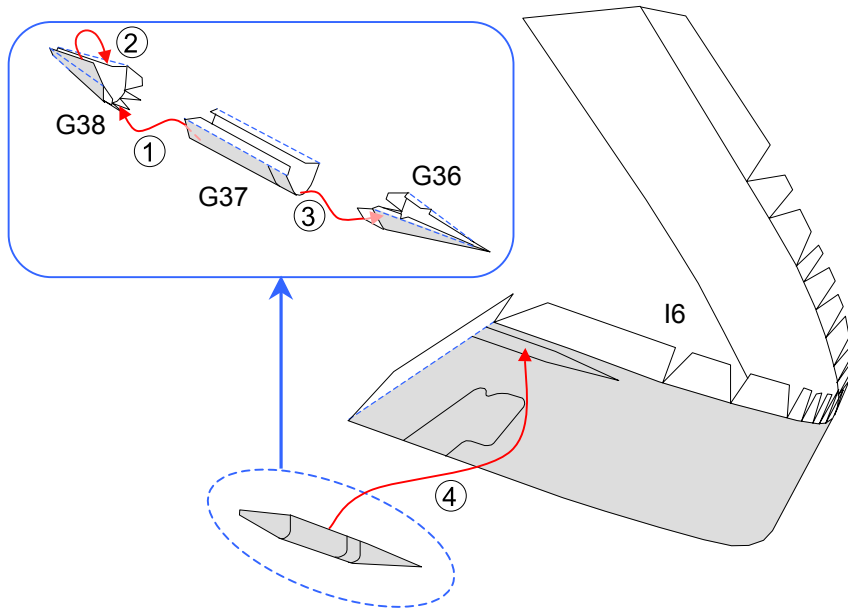
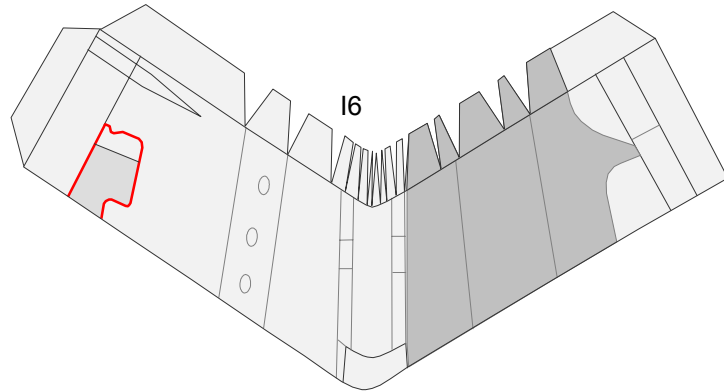

15.

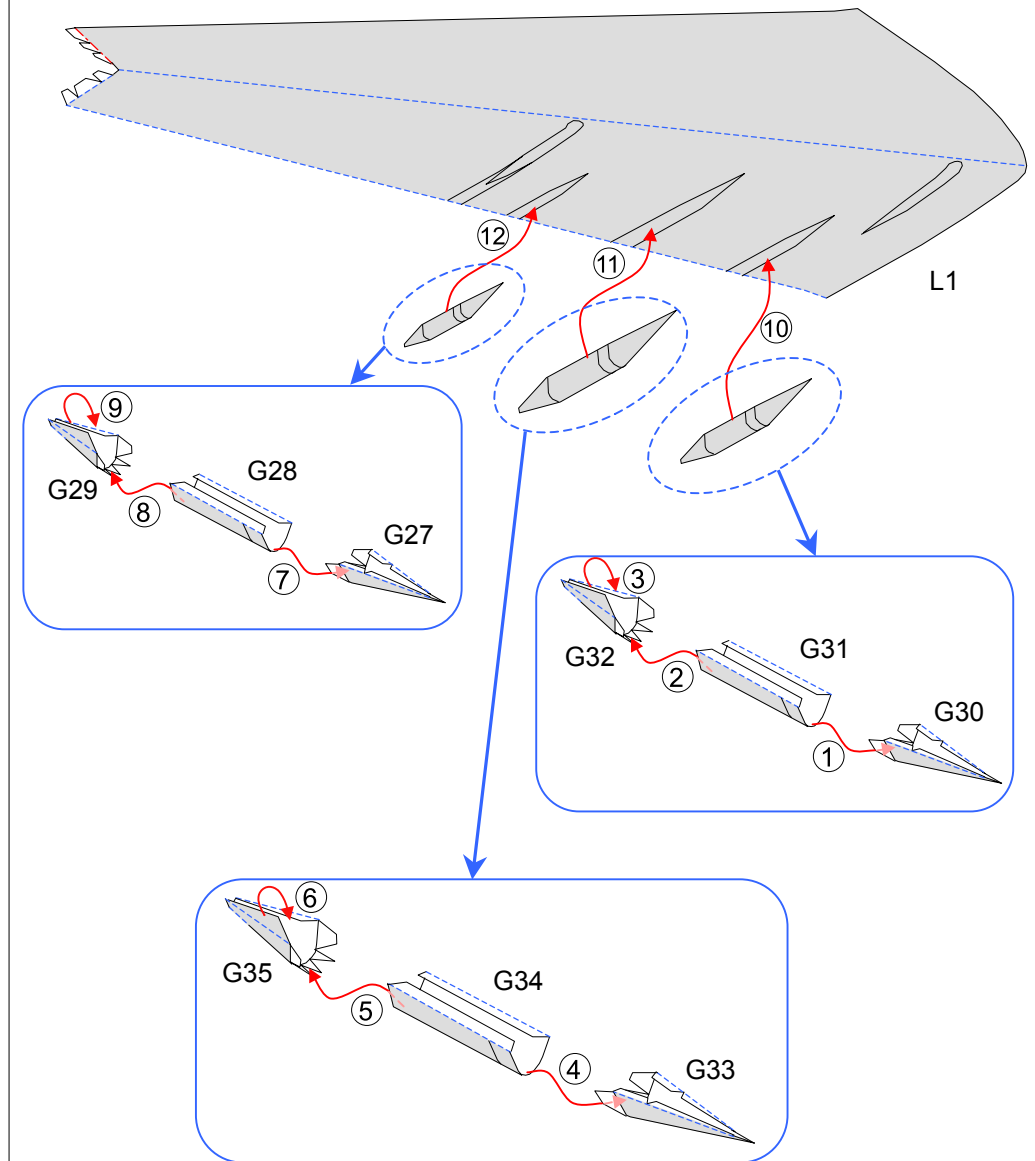

16.

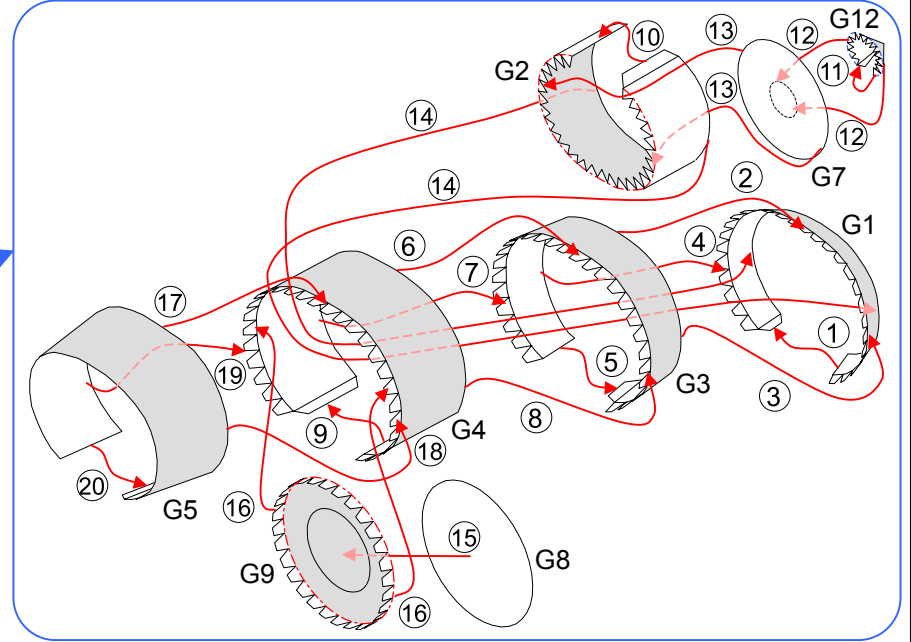
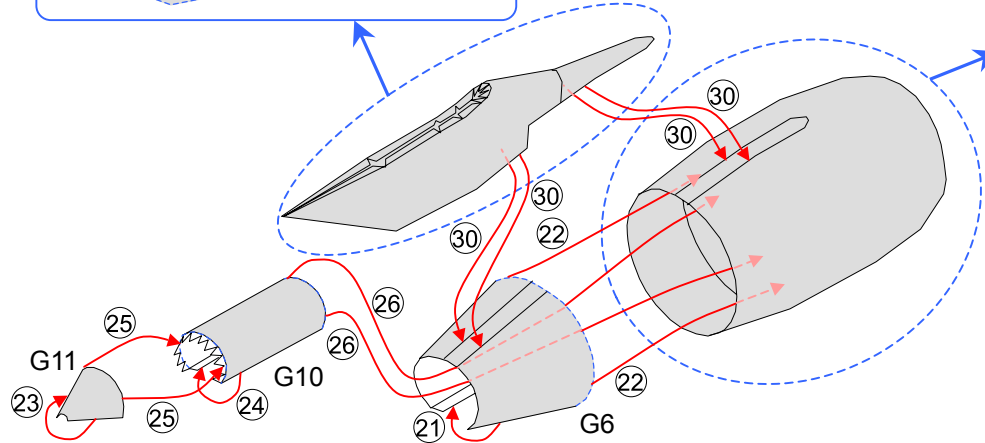
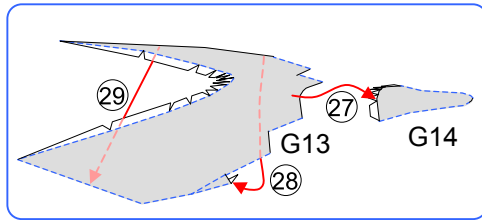

17.

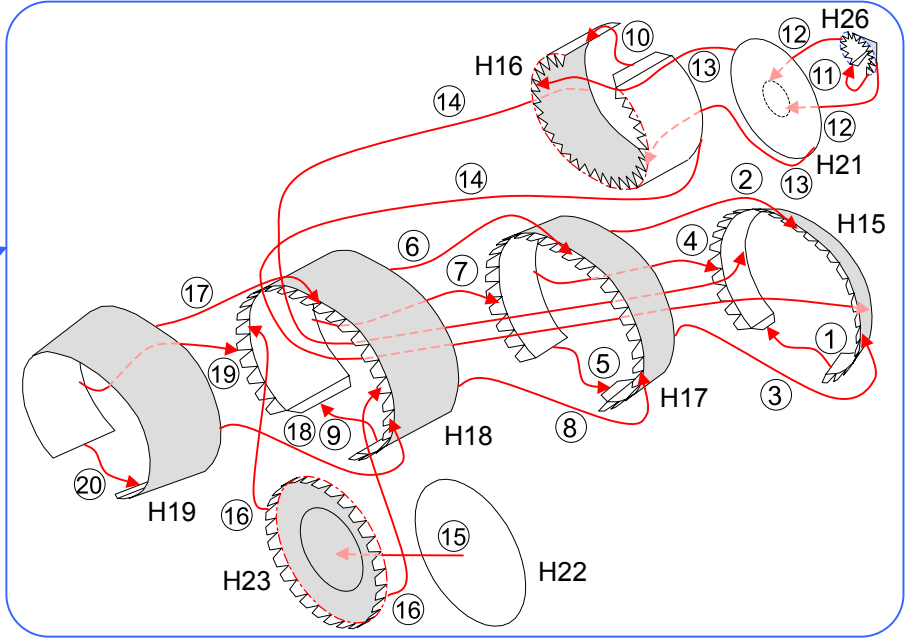
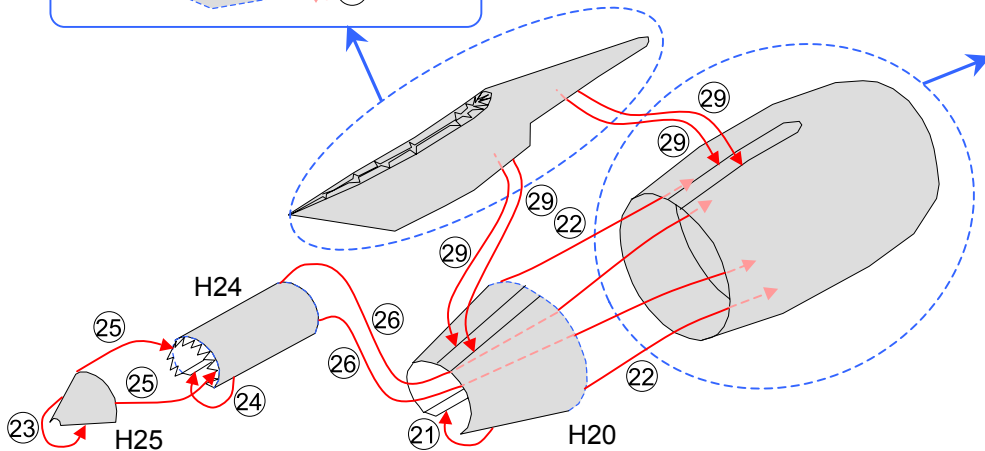
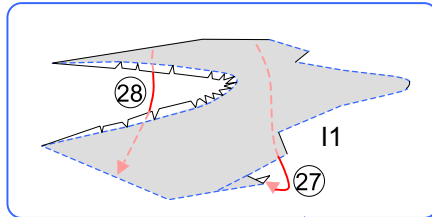

18.

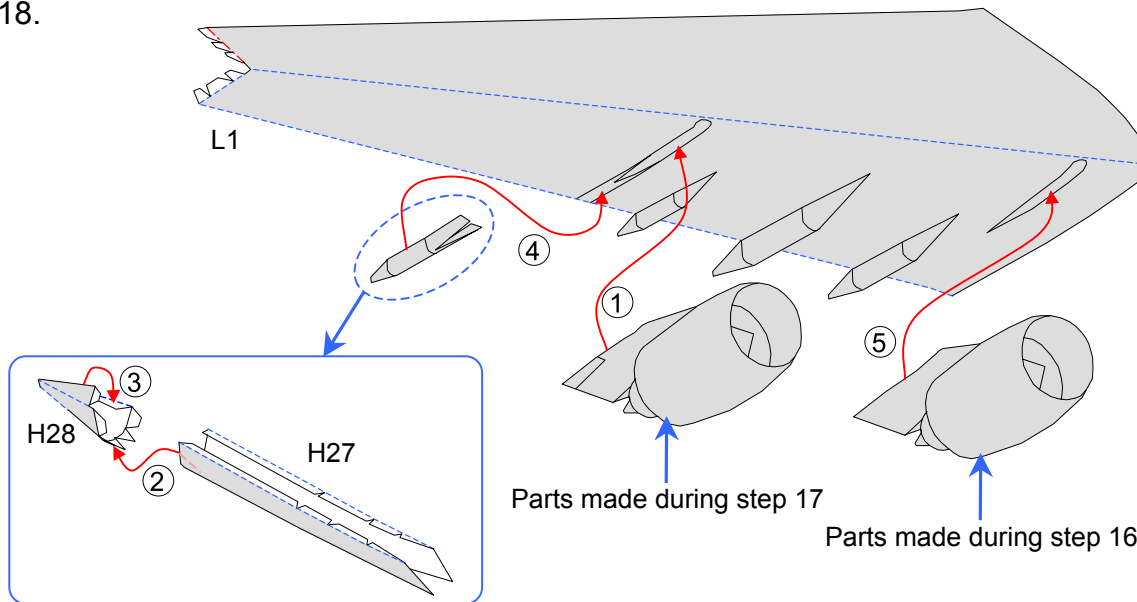

20.

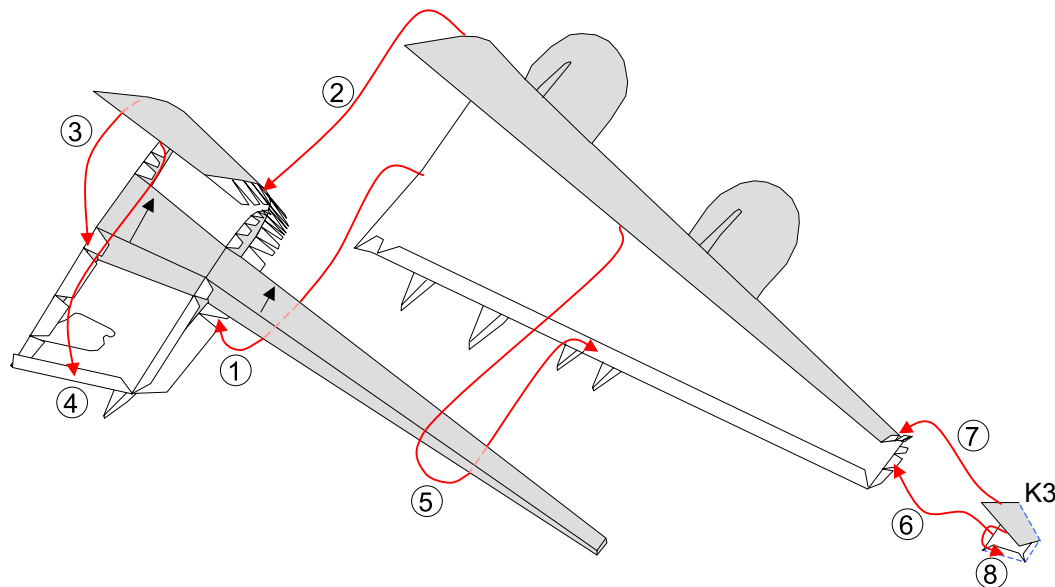

19.

If making a grounded model

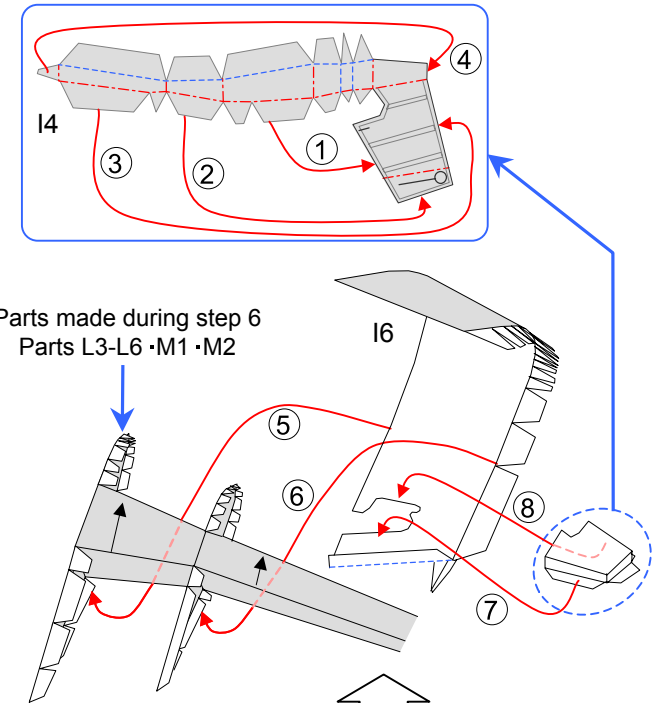

If making an in-flight model

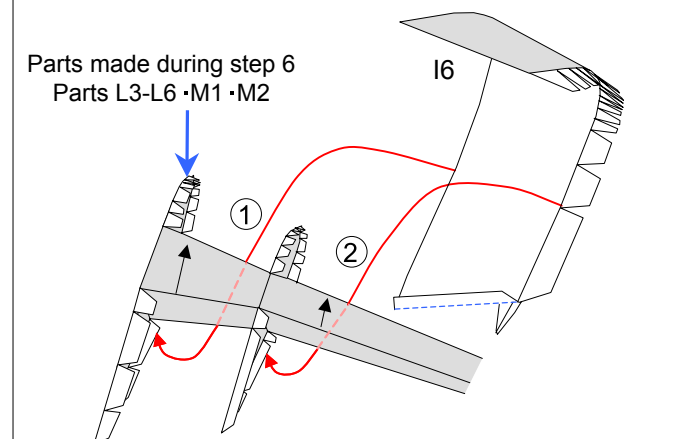

21.

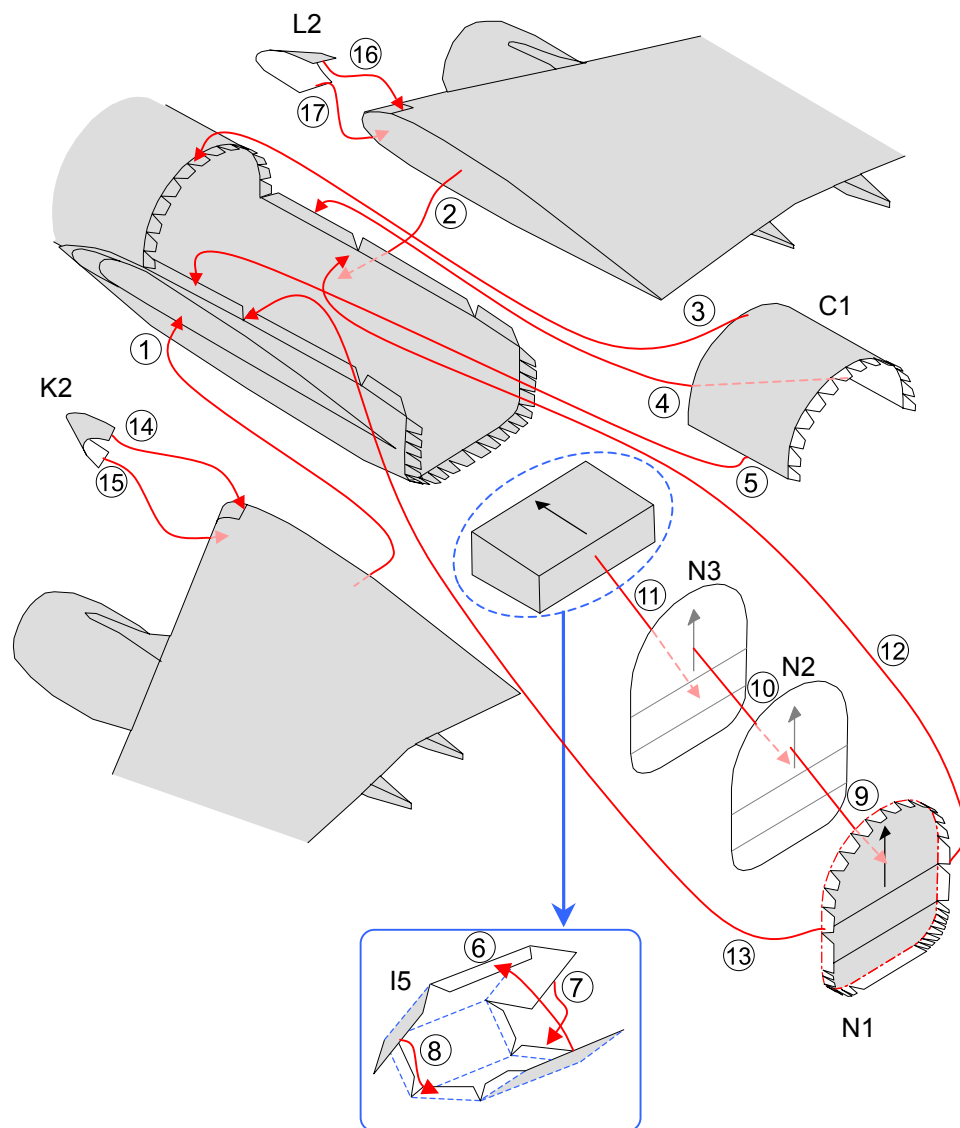

22.

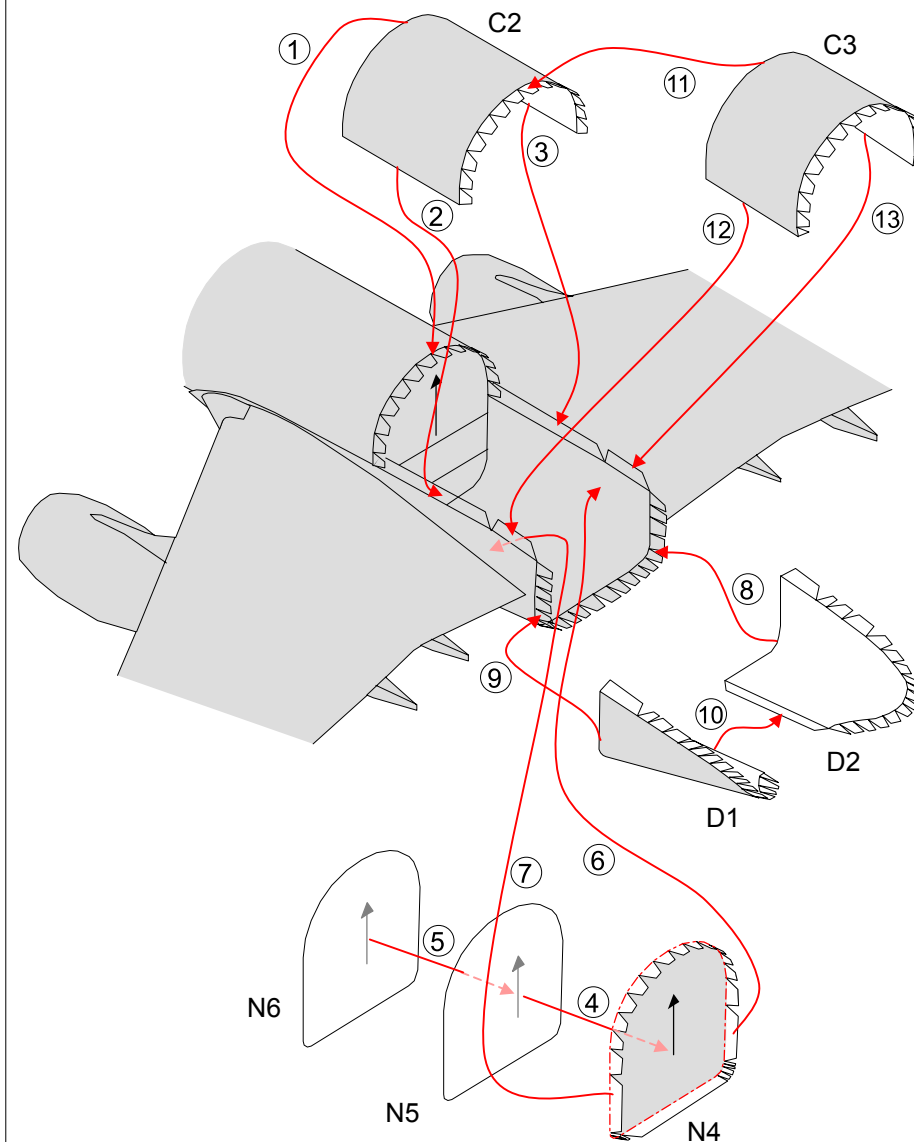

23.

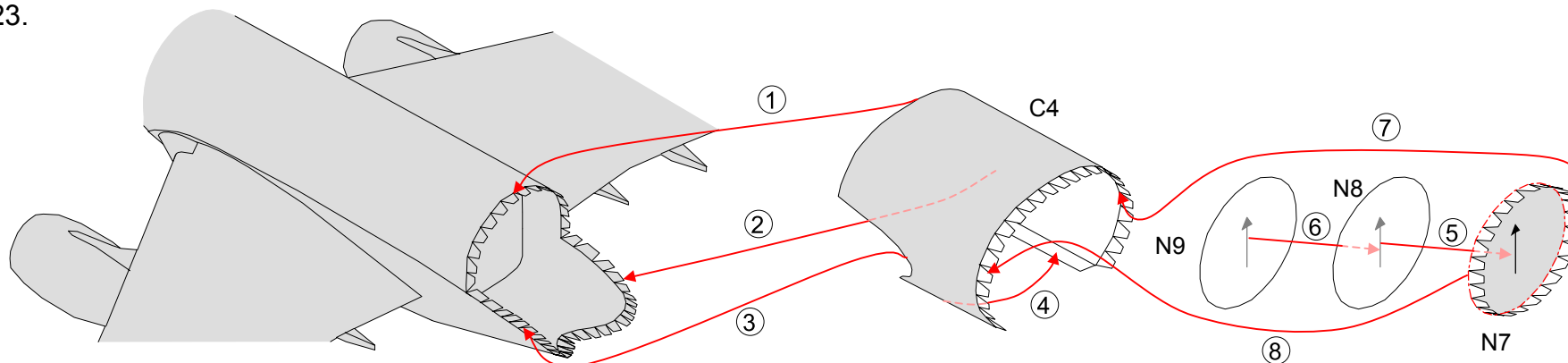

24.

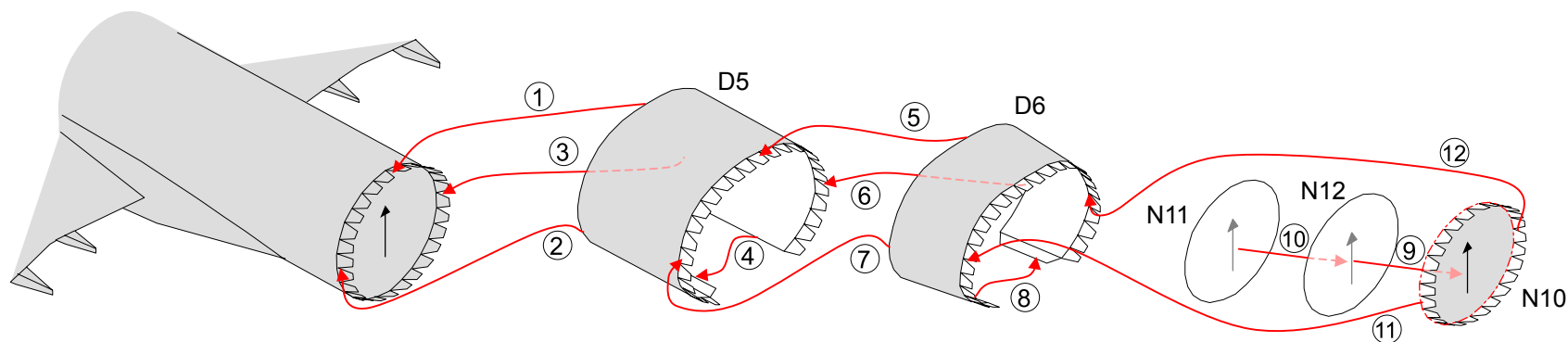

25.

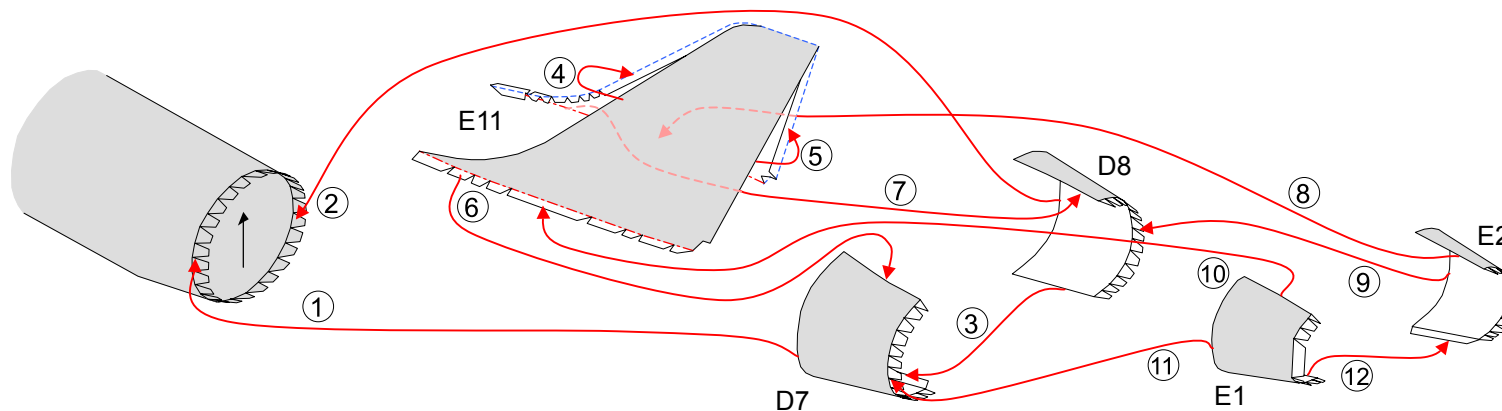

26.

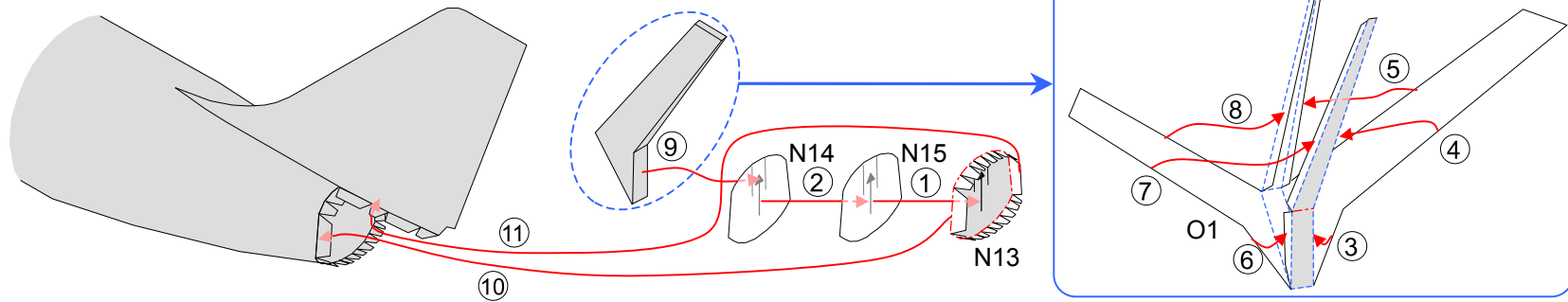

27.

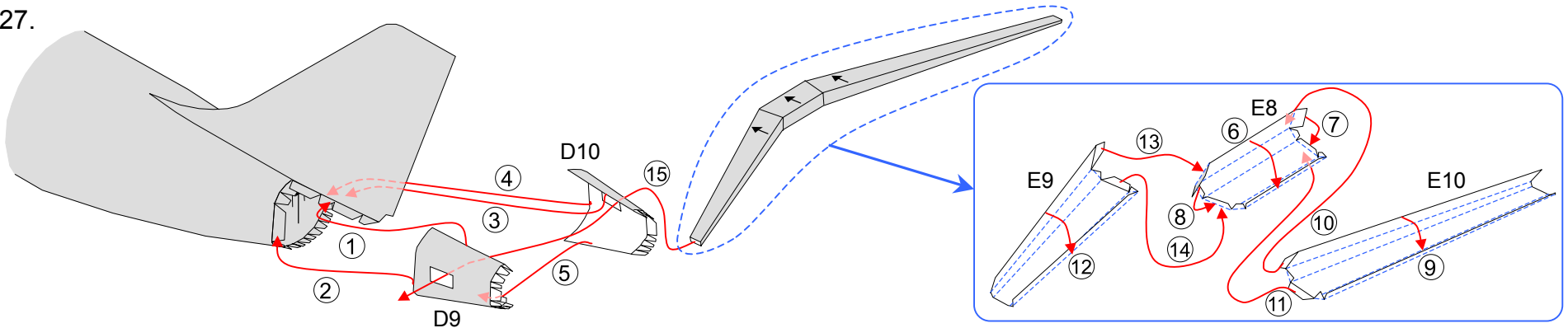

28.

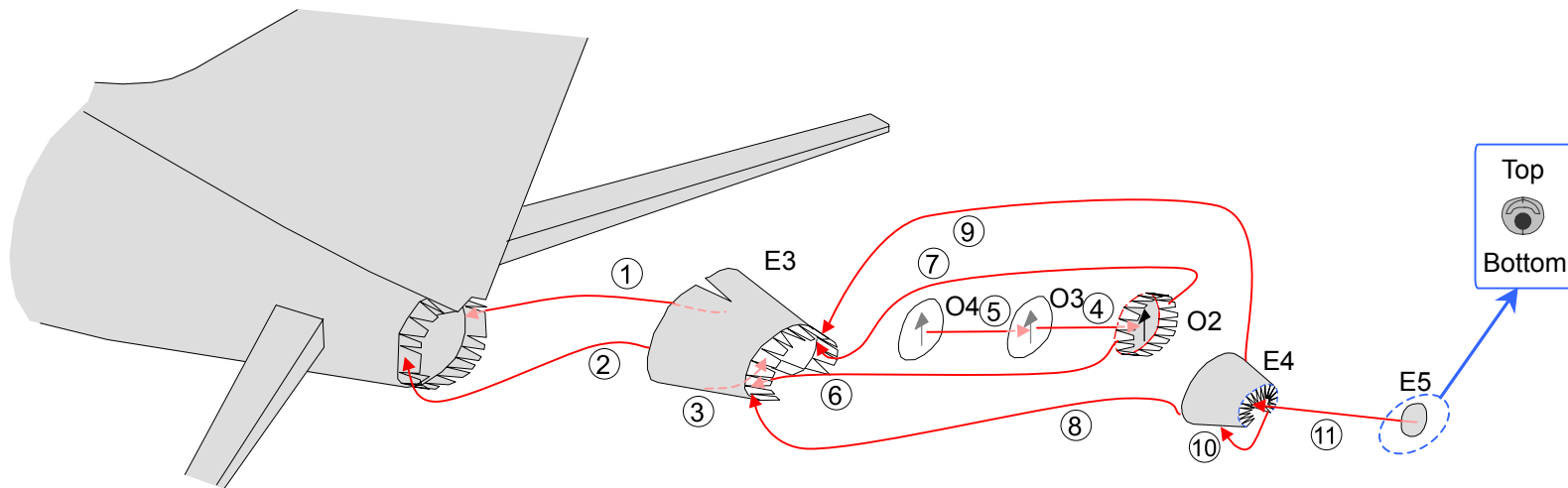

29.

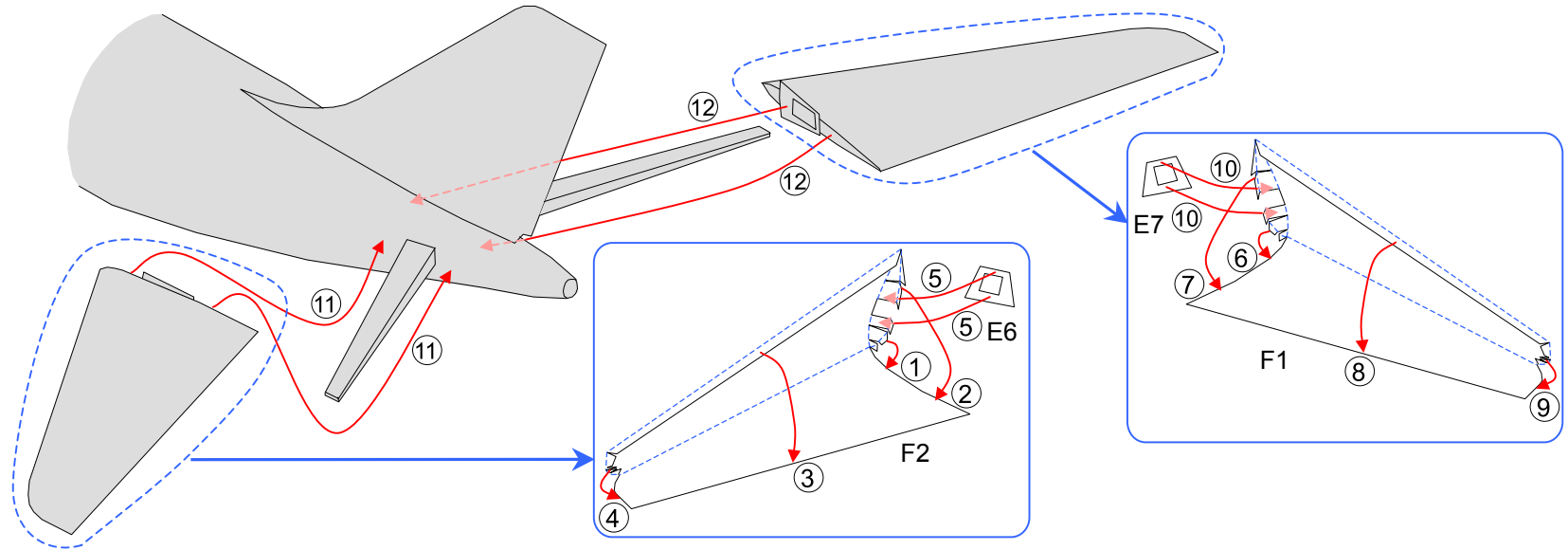

30. Carry out this step if making a grounded model

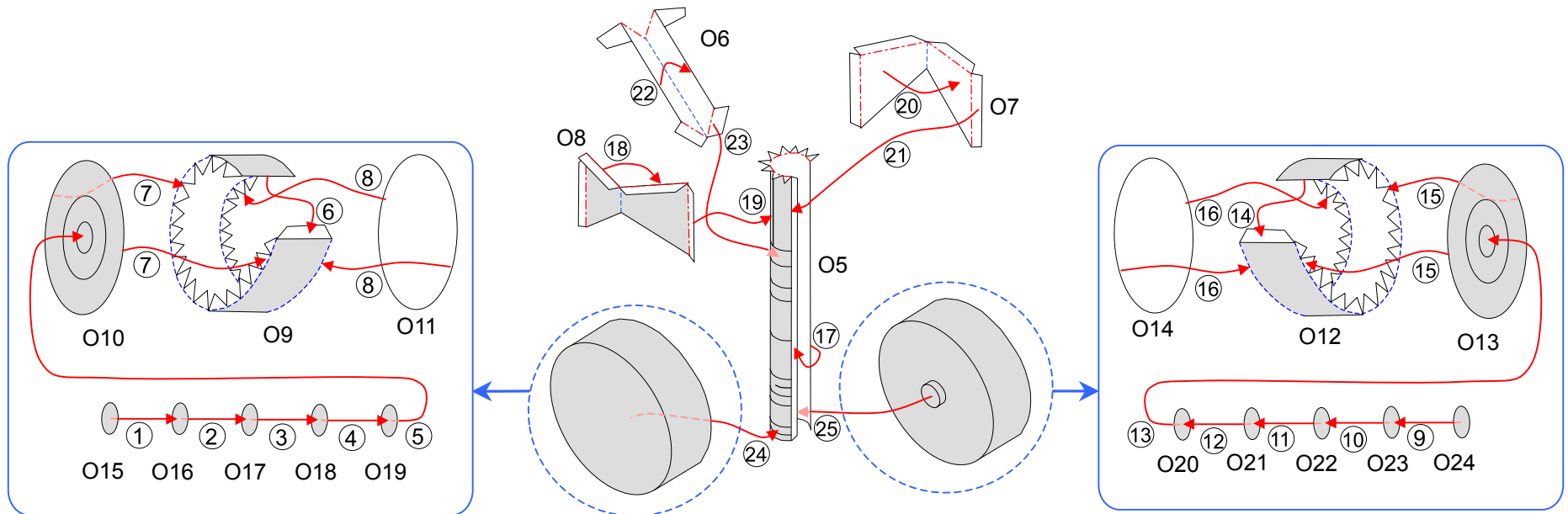

31. Carry out this step if making a grounded model
Make 12 pieces of parts 040-0111.

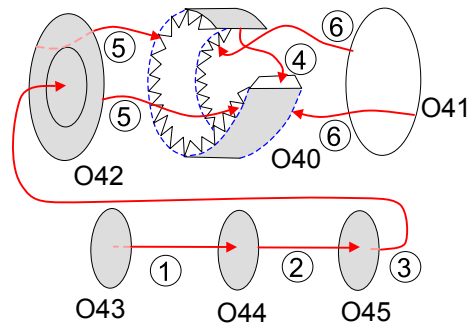

32. Carry out this step if making a grounded model

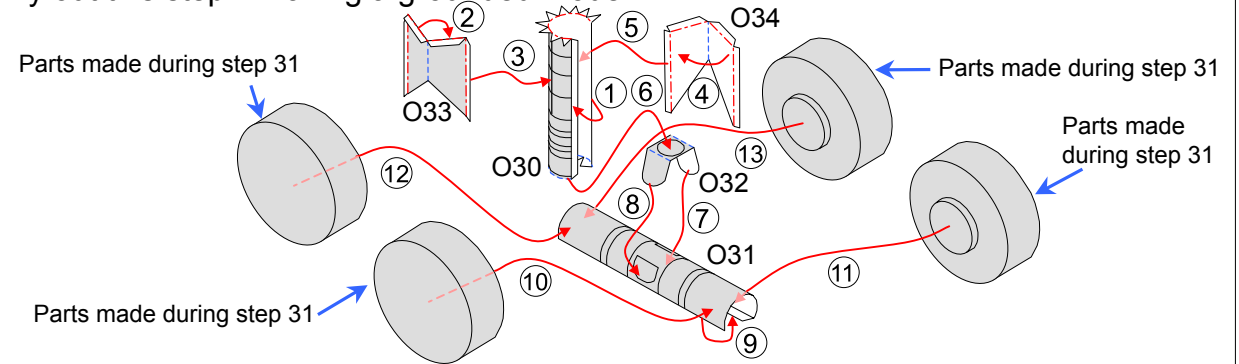

33. Carry out this step if making a grounded model

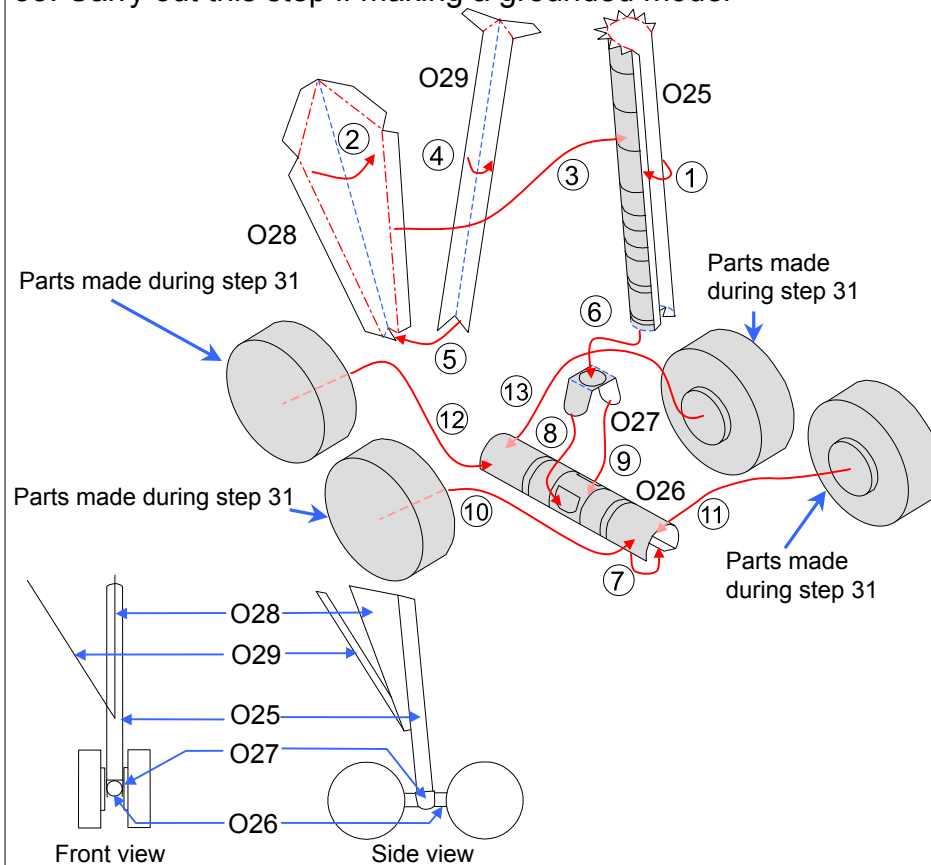

34. Carry out this step if making a grounded model

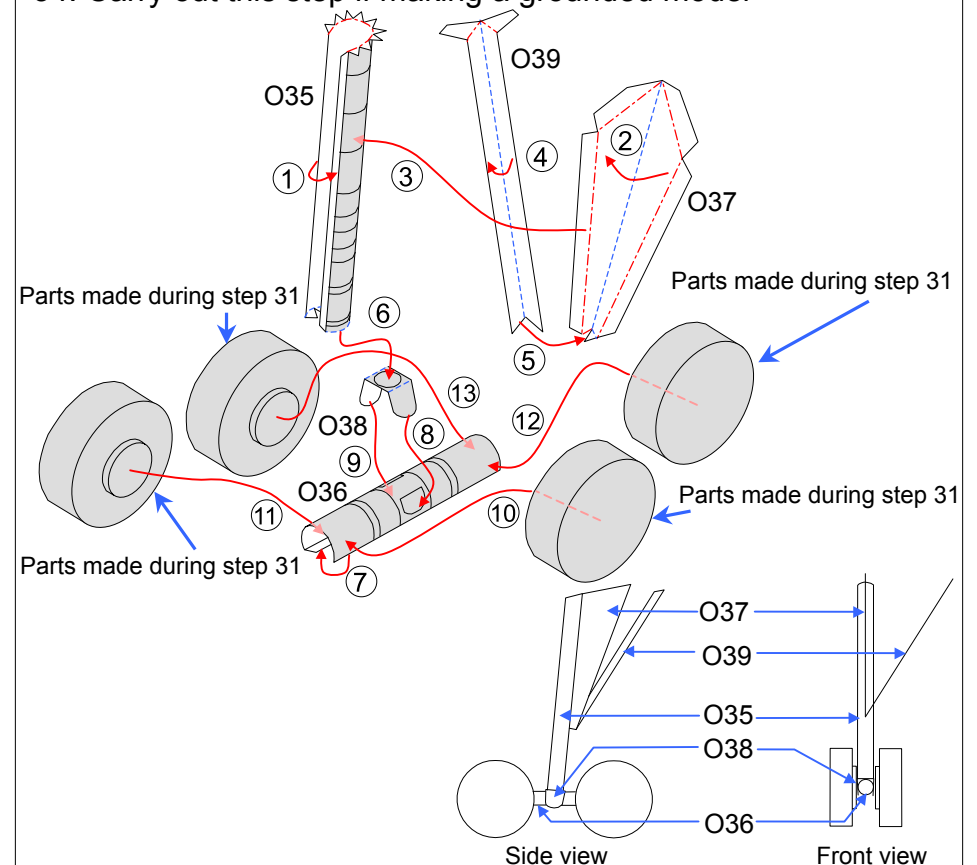

35. Carry out this step if making a grounded model

Attach the parts made during steps 30, 32, 33, and 34 first. Then, attach the other parts.

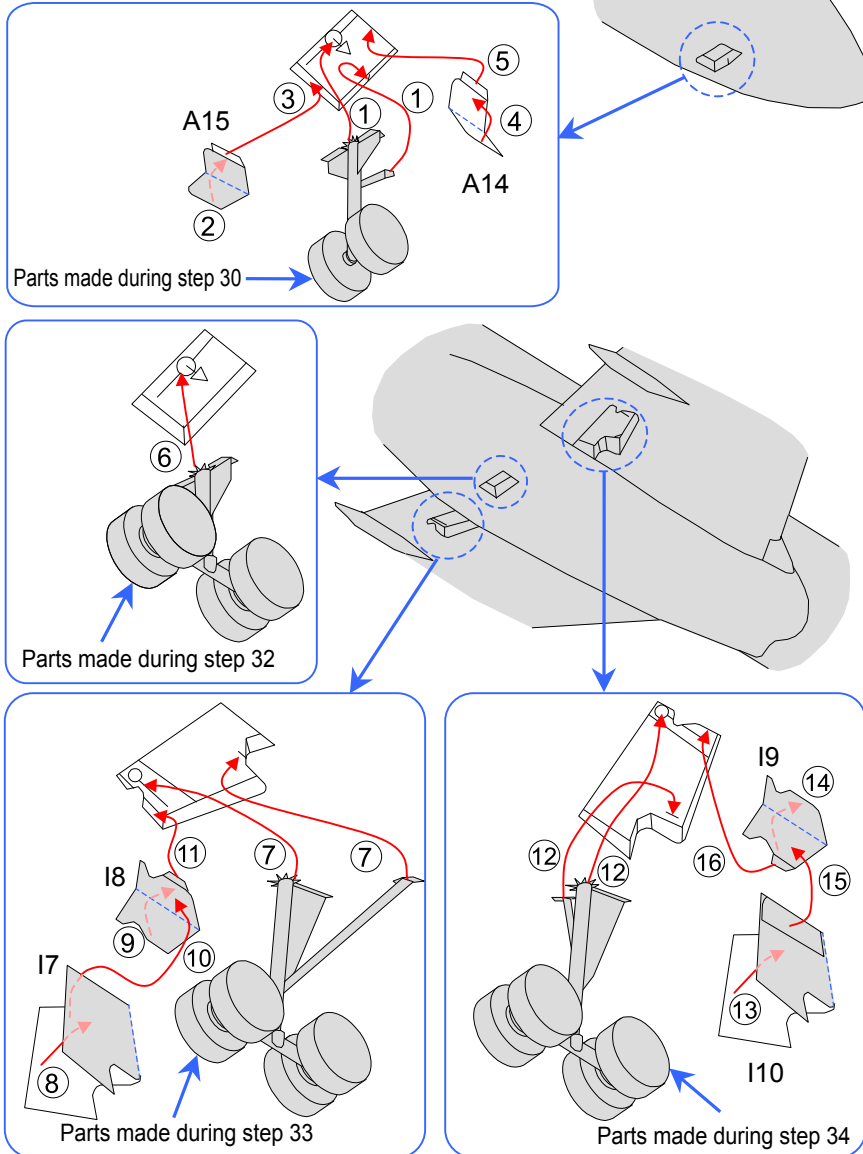

36.

