

## CREATIVE PARK

<http://www.canon.com/c-park/>



View of completed model

\* This model was designed for Papercraft and may differ from the original in some respects.

### Assembly Instructions : Five A4 sheets (No. 1 to No. 5)

\* Build the model by carefully reading the Assembly Instructions , in the parts sheet page order.

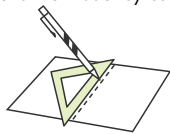

\*Hint: Trace along the folds with a ruler and an exhausted pen (no ink) to get a sharper, easier fold.

### Assembly Instructions



**Mountain fold(dotted line)**  
Make a mountain fold.



**Valley fold(dashed and dotted line)**  
Make a valley fold.



**Scissors line(solid line)**  
Cut along the line.



**Cut in line(solid line)**  
Cut along the line.

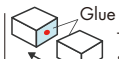

The glue spot(colored dot) shows where to apply the glue.

**● Glue spot(Red dot)**

Glue parts with the same number together.

**● Glue spot(Green dot)**

Glue within the same part.

**● Glue spot(Blue dot)**

Glue to the rear of the other part.

#### Tools and materials



Scissors, set square, glue(We recommend stick glue), pencil, used ballpoint pen, toothpicks, tweezers, (useful for handling small parts)

#### Assembly tip



Before gluing, crease the paper along mountain fold and valley fold lines and make sure rounded sections are nice and stiff.

#### Caution



Glue, scissors and other tools may be dangerous to young children so be sure to keep them out of the reach of young children.

Before starting assembly :  
Writing the number of each section on its back side before cutting out the sections is highly recommended.  
(\* This way, you can be sure which section is which even after cutting out the sections.)

→ Indicates where sections should be glued together.

After gluing, cut off or cut out.

### [Key points on making the ornamental parts around the roof edges]

- 1) Fold along the center line (to give angling) and glue the rear side
  - 2) Cut along the cutting lines (or red lines).
- \* Do not glue the valley fold parts, but open up to the outside to glue.

45 L

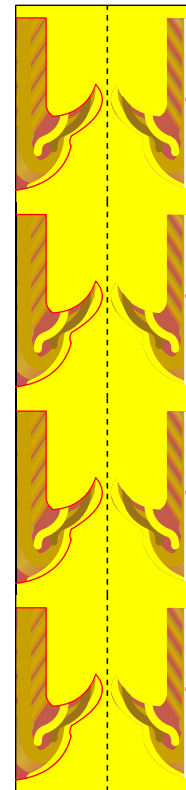

37

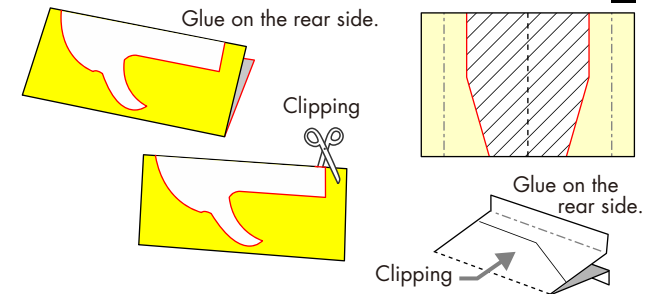

### [Key points at making the pillar parts]

- 1) It is easier to fold 2 or 3 pillars in a row on a part sheet.

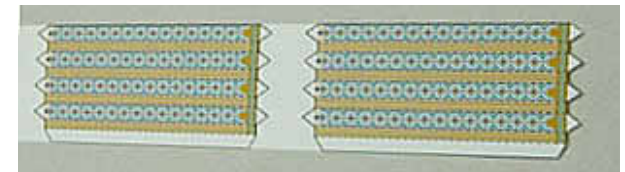

- 2) Firmly fold the octagonal folding lines and glue together.

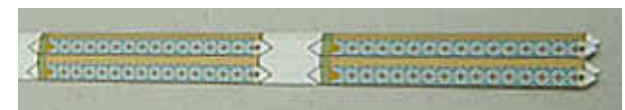

- 3) After gluing, cut out the pasting margins at the top and bottom.



# Temple of the Emerald, Thai : Assembly Instructions

Assemble the main body and the first level of the roof.

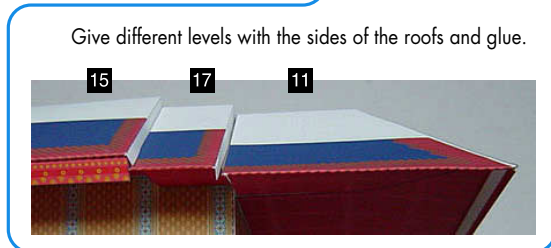
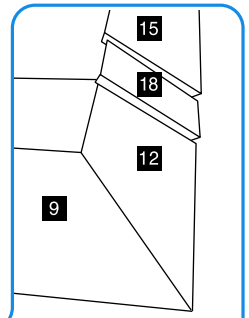
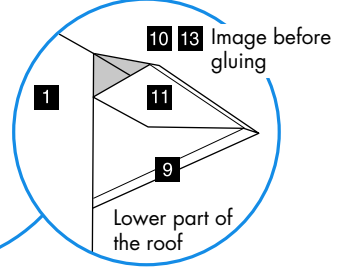
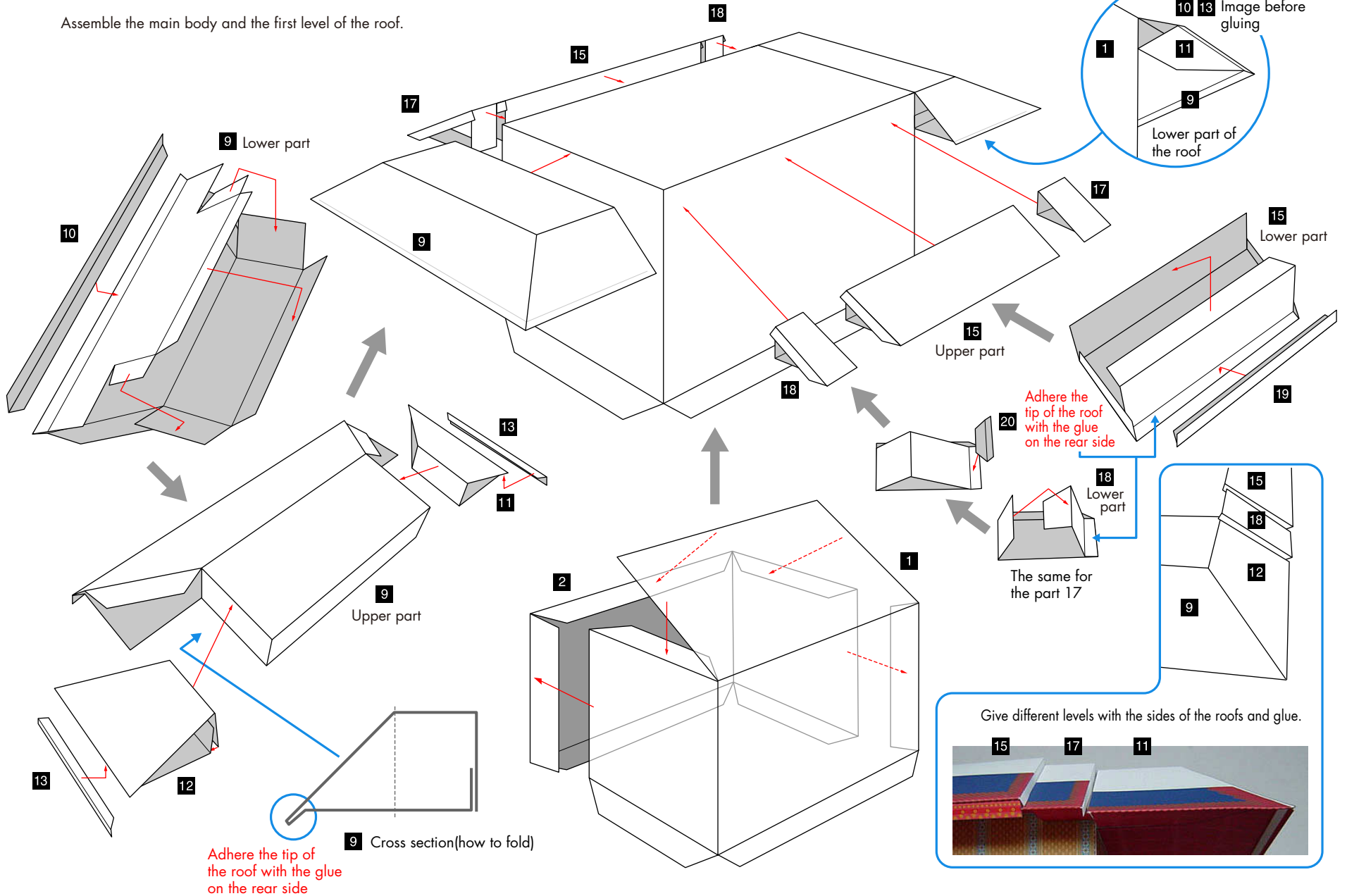

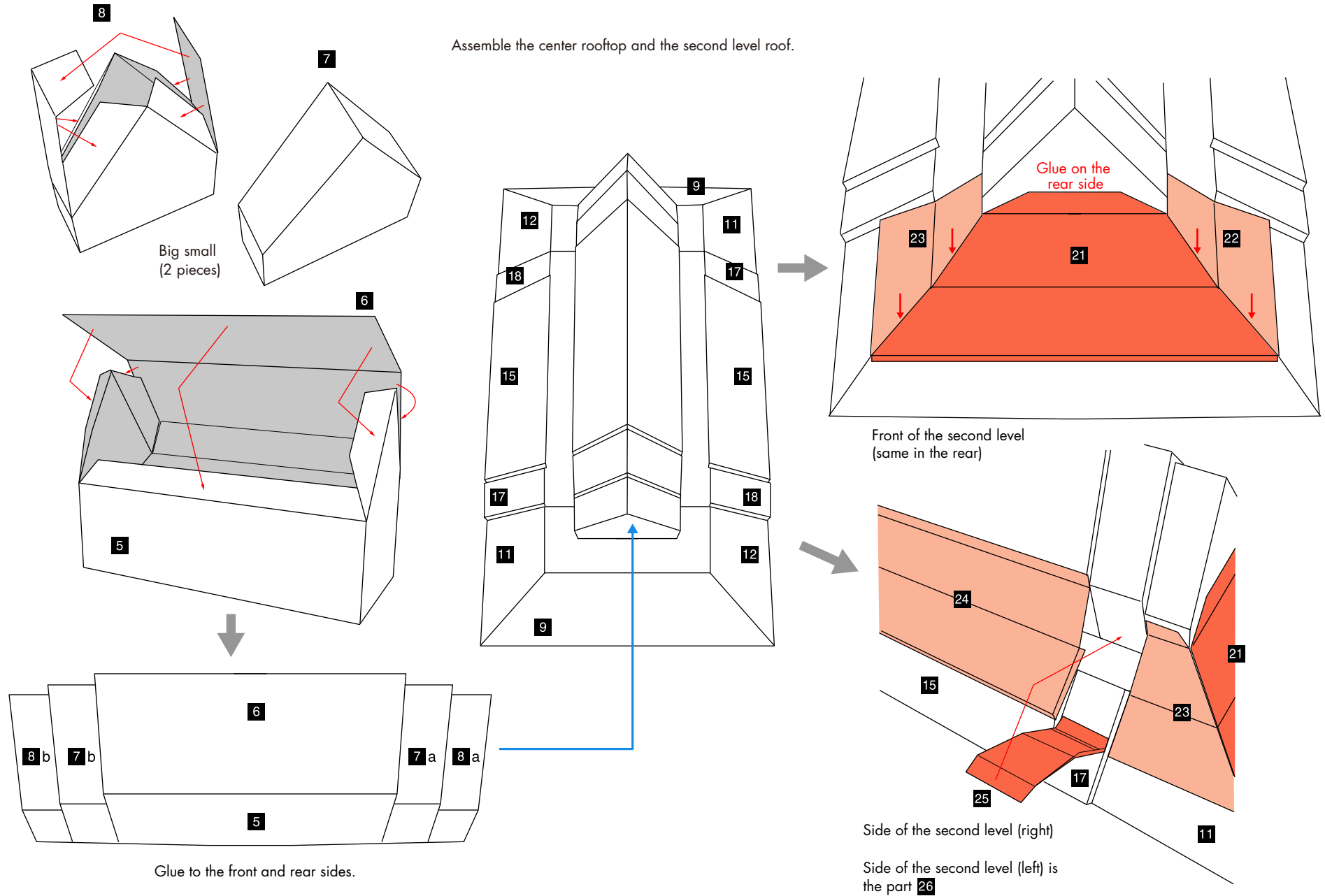

# Temple of the Emerald, Thai : Assembly Instructions

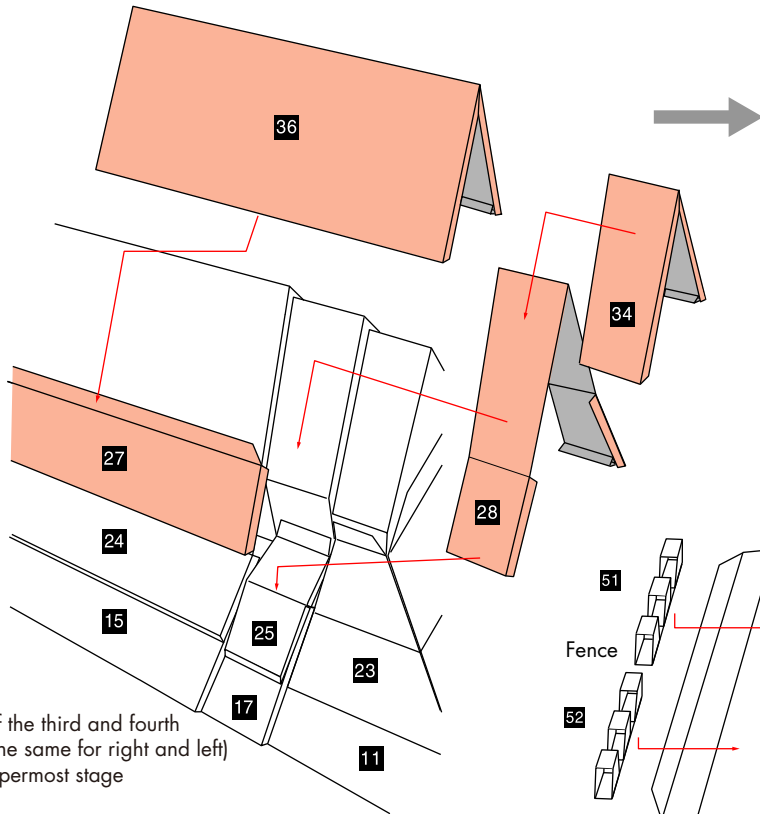

Side of the third and fourth level (the same for right and left)  
The uppermost stage

Assemble the third, fourth level roof and the uppermost stage.

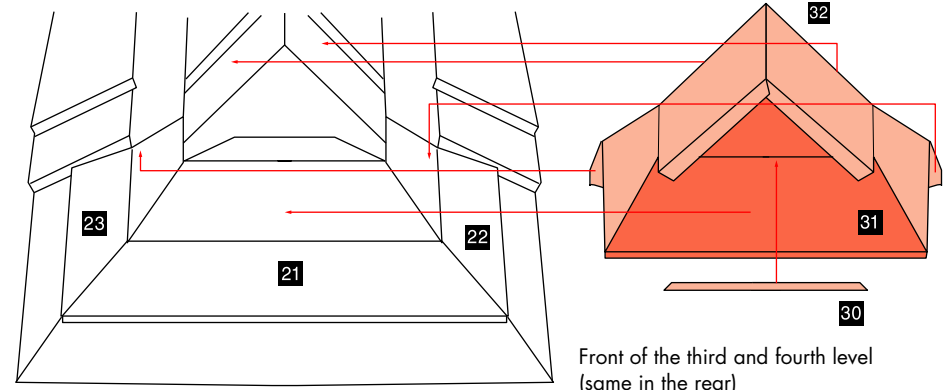

Front of the third and fourth level  
(same in the rear)

Assemble the "floor" and glue the "fences" on four sides.  
Next, assemble the basement, glue the main body on the floor,  
and then glue on the basement.

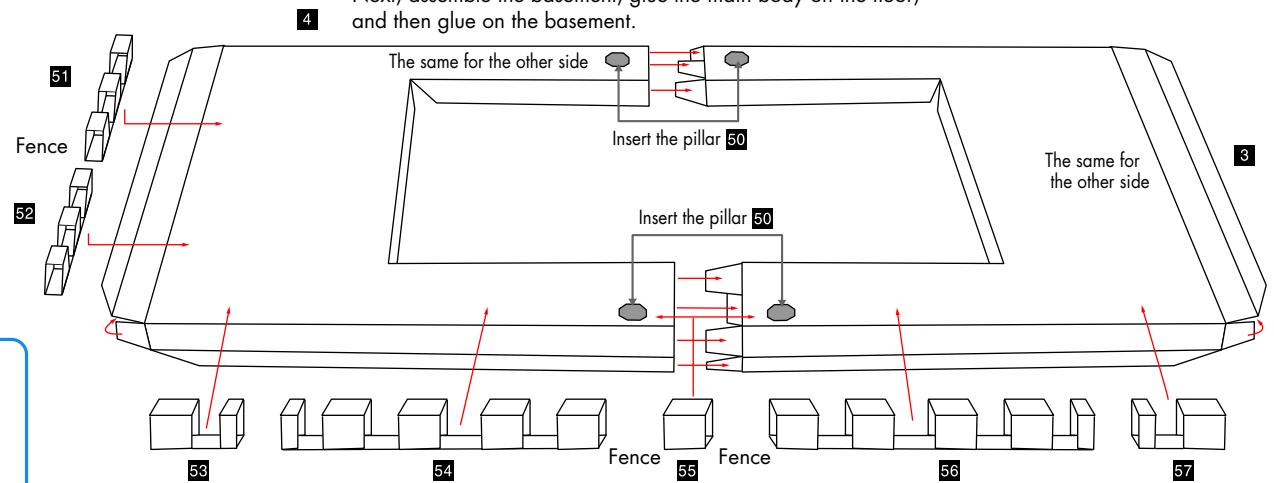

The same for the other side

Insert the pillar 50

The same for the other side

Insert the pillar 50

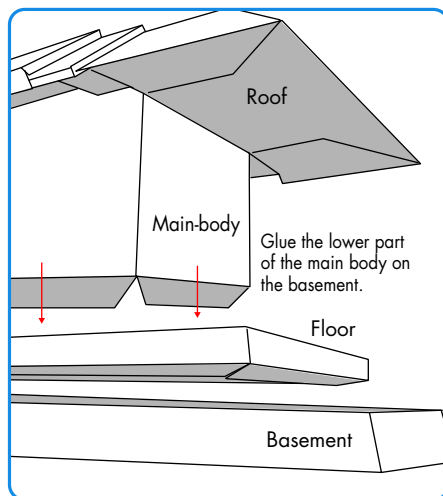

Glue the lower part  
of the main body on  
the basement.

Assemble a basement

# Temple of the Emerald, Thai : Assembly Instructions

See the key points on making on p.1 in the assembly manual and assemble octagonal pillars (5 types). For the 4 "pillars 50" on the center part of the sides of the "floor", insert them (to the rear of the "pasting margin" of the floor) and glue. Check the tilting and how they stand, and glue the pillars (top and bottom) to the specified locations in the following order.

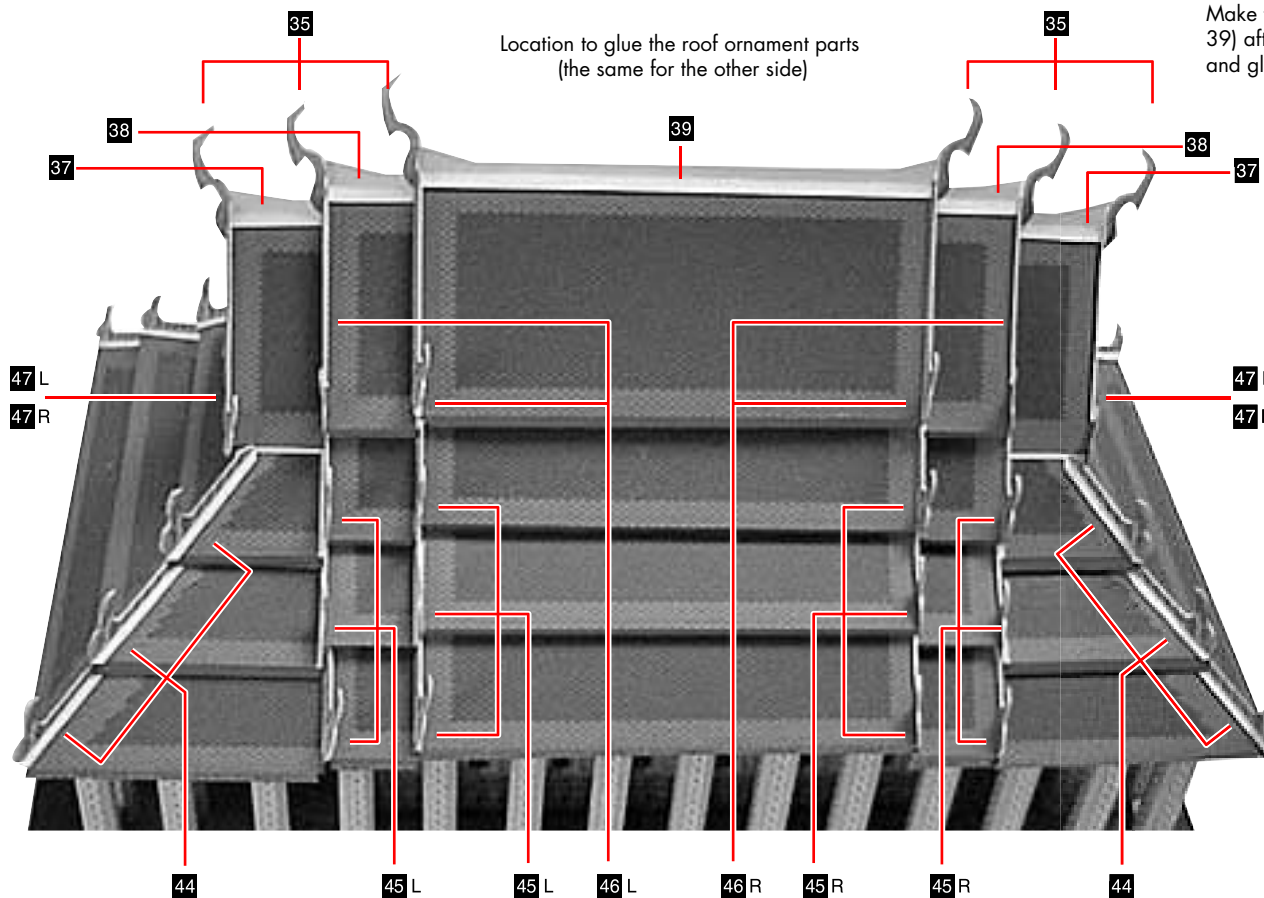
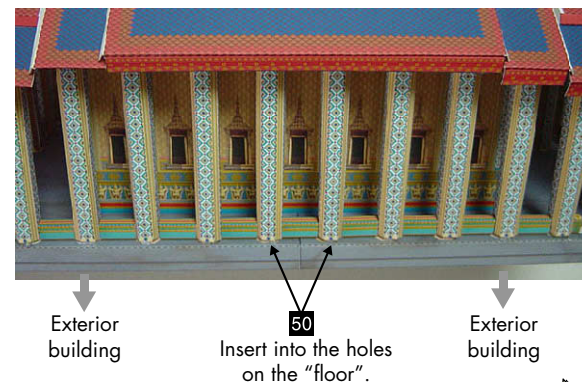
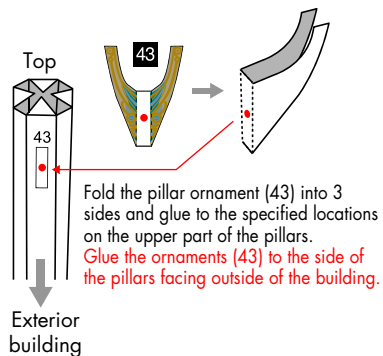
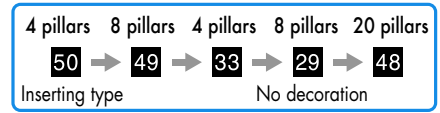

Make the parts (37, 38 and 39) after holding the part (35), and gluing on to the roof.

