



A mikoshi is a Japanese portable shrine that is used in festivals to transport the spirit of a deity. Mikoshi are often built to resemble an actual shrine. They are usually made from wood, with extravagant gold and silver decorations and beautiful engravings, and a phoenix or other creature on the roof. The two poles that run through it make it possible for a group of people to carry it, bearing it on their shoulders as they transport it around at the festival.

*This model was designed for Papercraft and may differ from the original in some respects.
*In this picture, the edges of the completed model have been touched up with paint.



- Parts sheet (Pattern) : Eighteen A4 sheets
- No. of Parts : 166 parts
- Assembly Instructions : Thirteen A4 sheets

**Build the model by carefully reading the Assembly Instructions, in the parts sheet page order.*

Hint

- ☆ Write down the number on the back of each part as you cut them out.
- ☆ Since many of the parts are complicated and very small, do a trial assembly before actually attaching them together.
- ☆ The finished piece will look more realistic if you paint the edges of the parts with colors similar to the parts.

Assembly Instructions

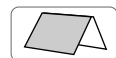

----- Mountain fold(dotted line)
● Make a mountain fold.

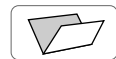

- - - - - Valley fold
(dashed and dotted line)
● Make a valley fold.

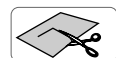

— Scissors line (solid line)
● Cut along the line.



— Cut In Line (solid line)
● Cut along the line.

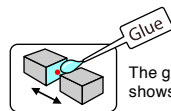

The glue spot(colored dot) shows where to apply the glue.

- Glue spot (Red dot)
Attach the parts with the same part numbers.
- Glue spot (Green dot)
Glue within the same part.
- Glue spot (Blue dot)
Glue to the rear of the other part.

Tools and materials



Scissors, set square, glue (We recommend stick glue),pencil, used ballpoint pen, toothpicks, tweezers, (useful for handling small parts)

Assembly tip

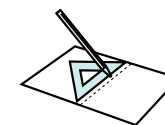

Trace along the folds with a ruler and a used pen (no ink) to get a sharper, easier fold.

Caution



Glue, scissors and other tools may be dangerous to young children so be sure to keep them out of the reach of young children.

Assemble the sawhorses (the mikoshi stand)

Use the 2nd and 3rd page of the parts sheets.

*Make two pairs.

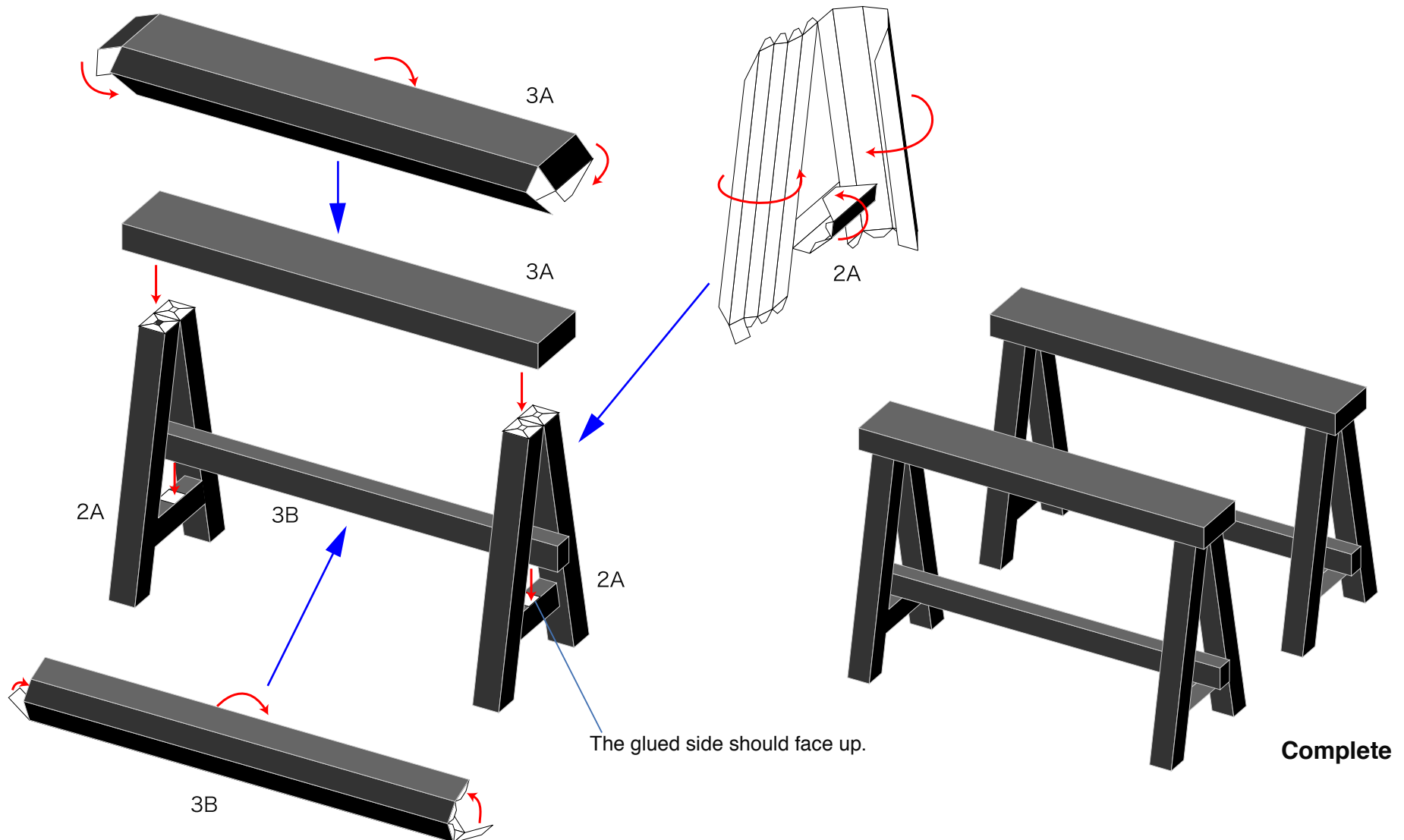

Assemble the base

Use the 4th and 5th page of the parts sheets.

*After assembling 5A, attach 4A. (Make two 5As.)

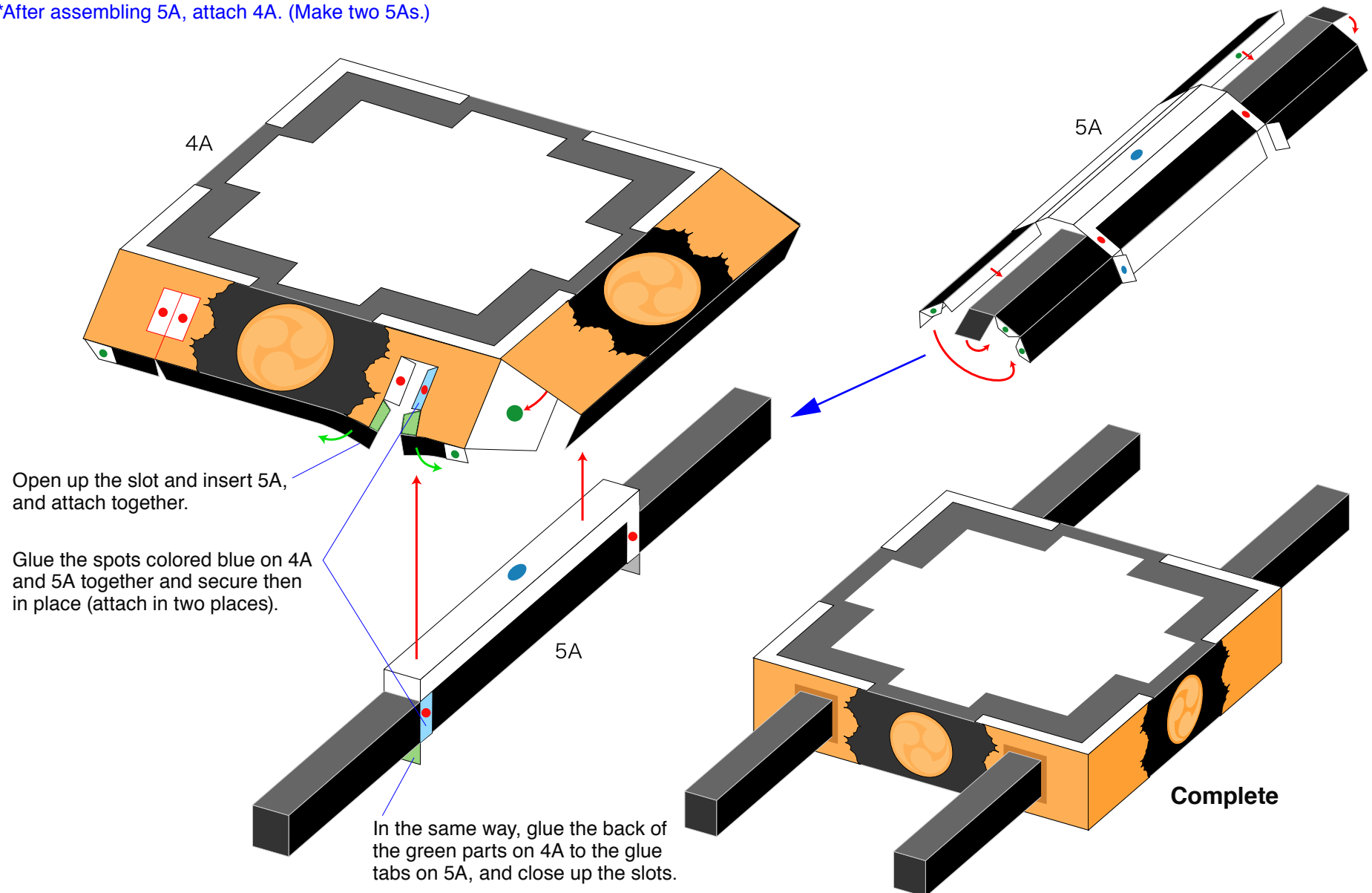

Assemble the steps and lower part of the body

Use the 4th and 7th page of the parts sheets.

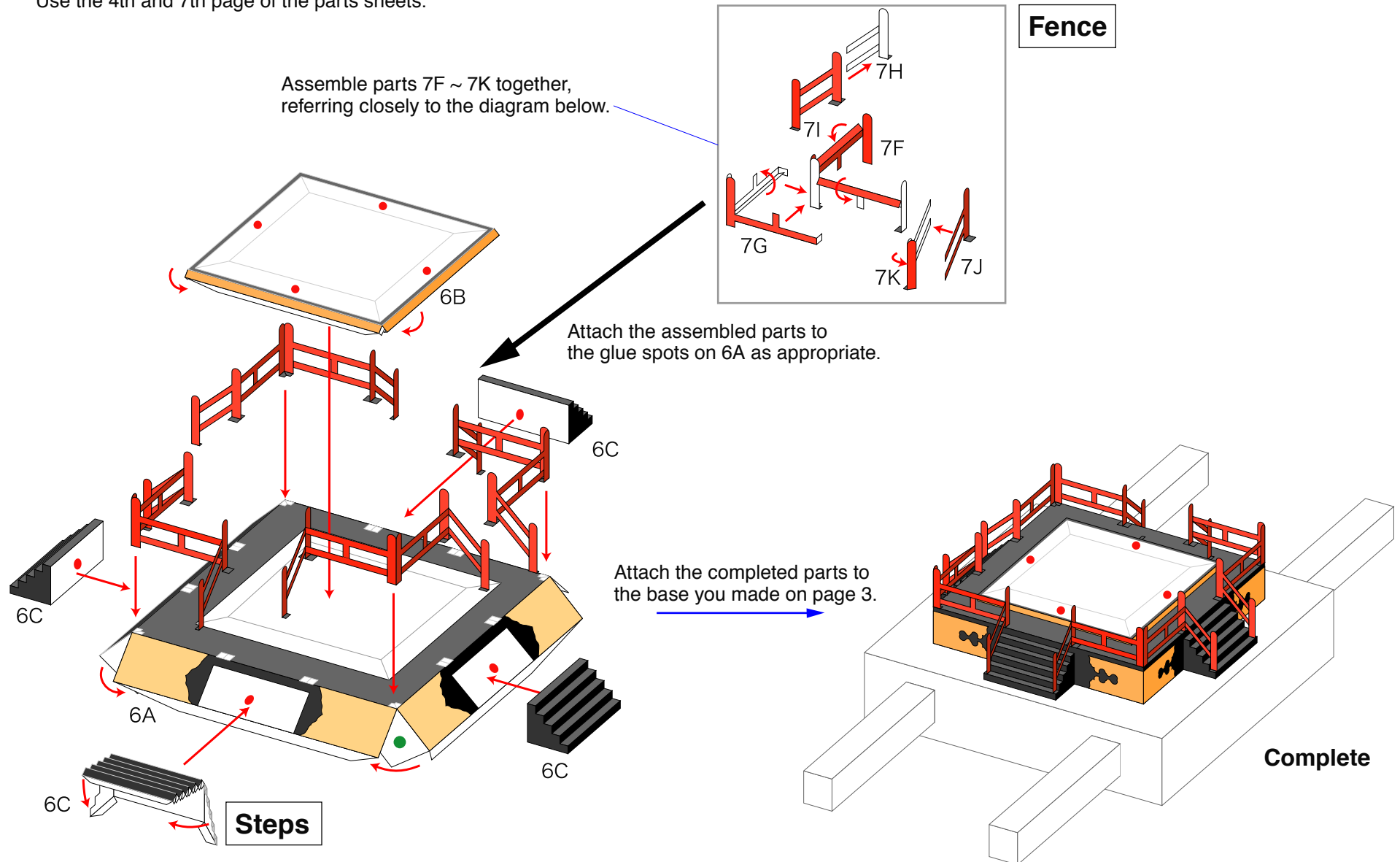

Assemble the main part

Use the 9th page of the parts sheets.

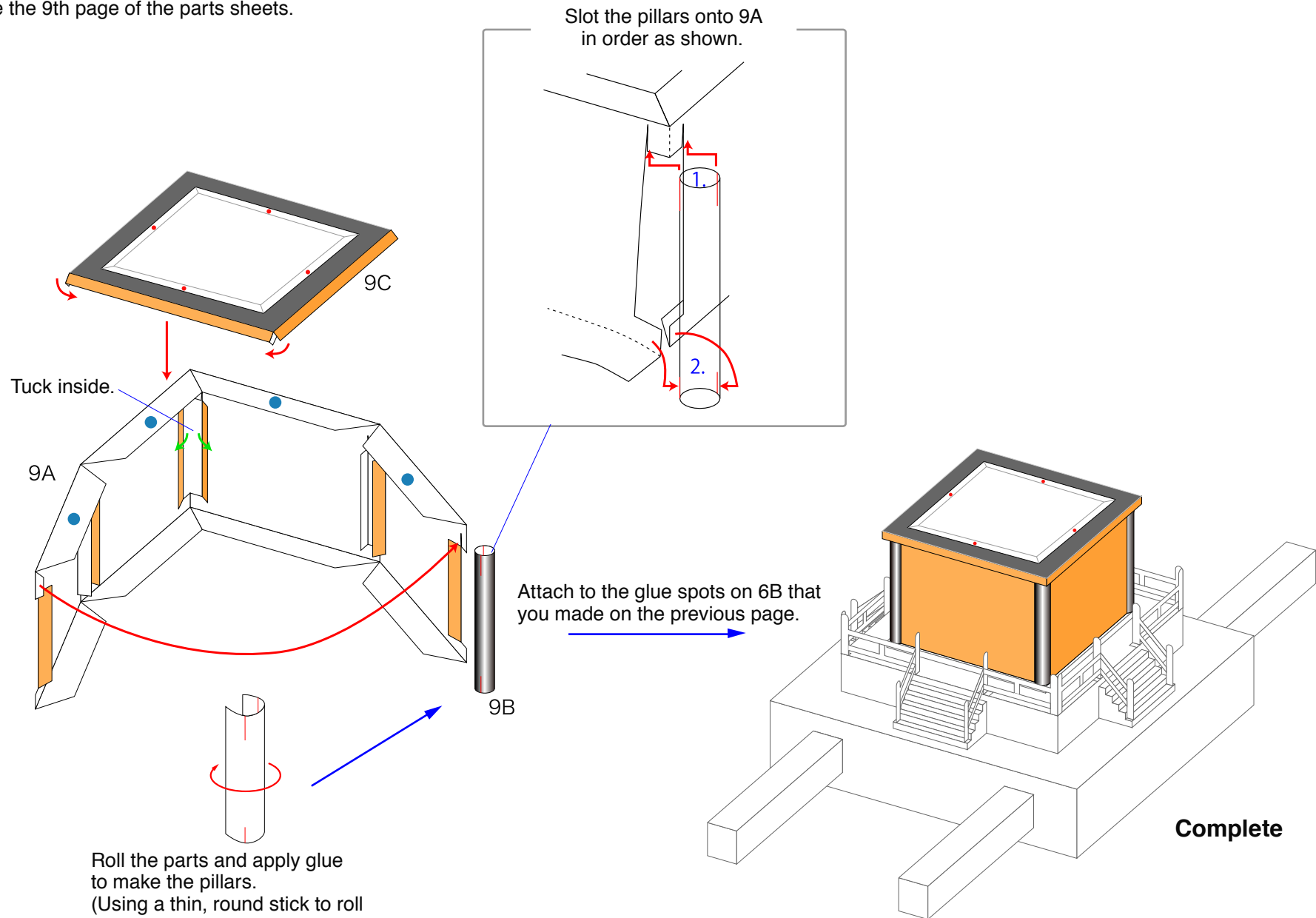

Assemble the shrine gate and fence

Use the 4th and 8th page of the parts sheets.

*Assemble four each of the torii and fences.

Shrine gate

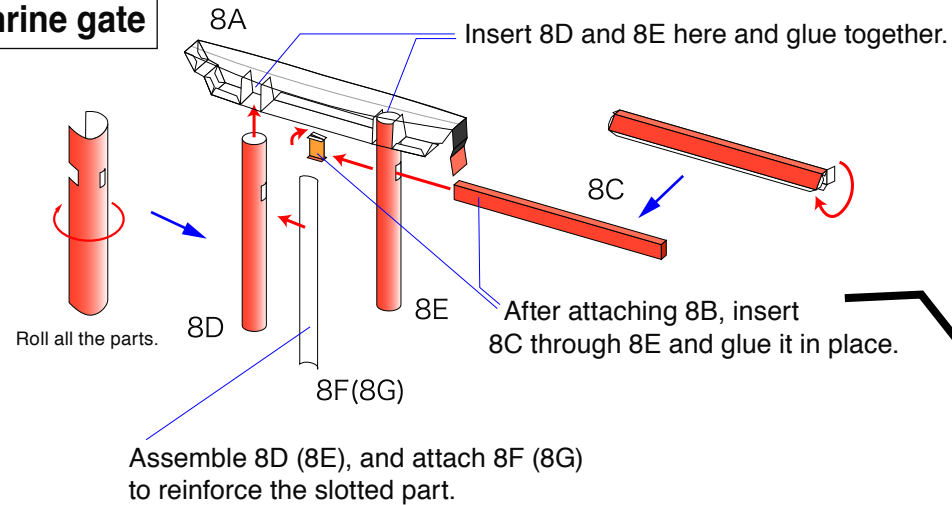

Fence

Fold along the fold lines on 7D (7C), glue them together at the back and attach to 7A. At this point, attach the edge to the glue tabs on 7B and secure them in place.

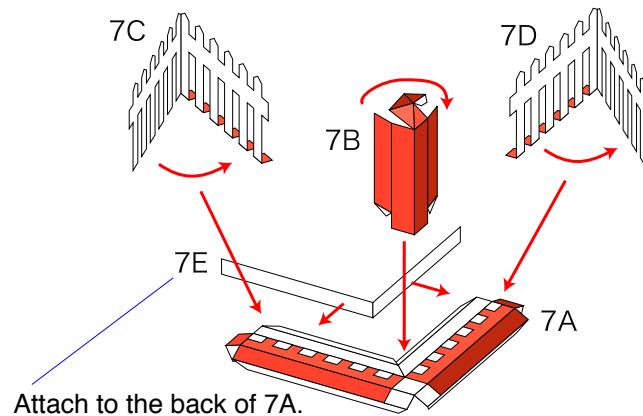

Make a valley fold on the top part of 8A, and adjust the shape so that the middle is indented slightly.

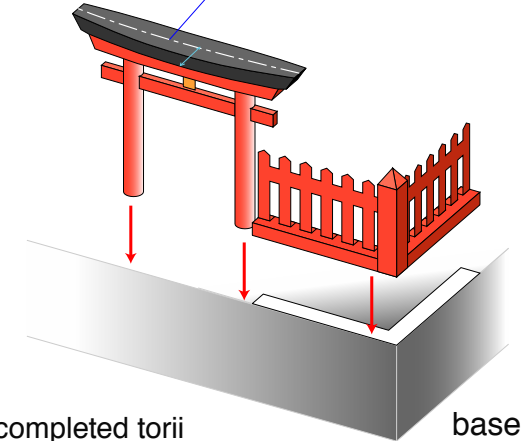

Attach the completed torii and fences to the base.

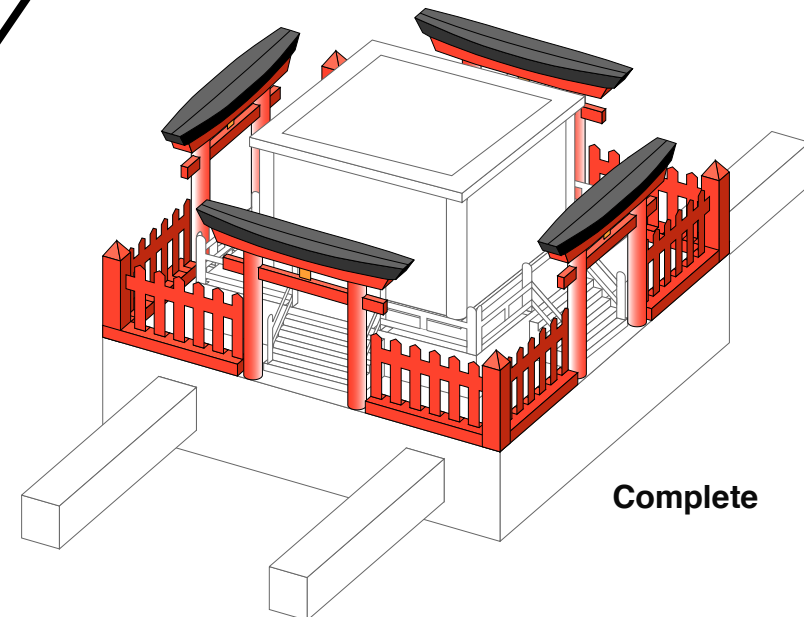

Assemble the bracket complex and roof

Use the 10th and 11th page of the parts sheets.

Bracket complex

*How to join the four corners

Fold and attach so that they overlap each other.

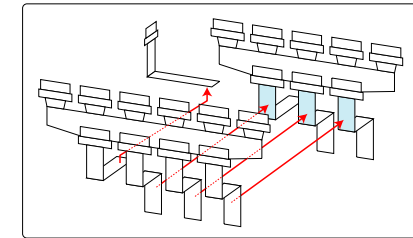
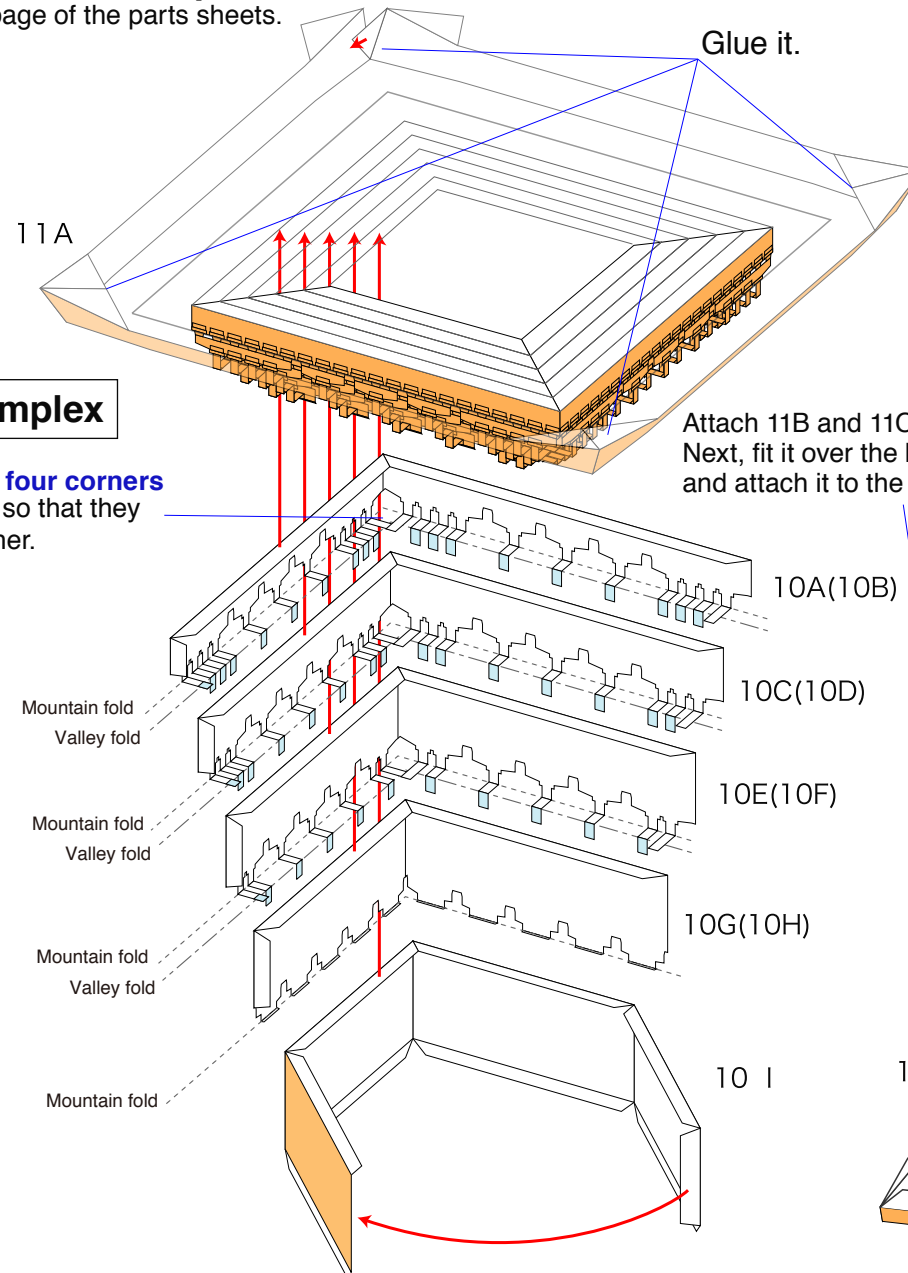

Attach the glue tabs as appropriate, using the light blue colored areas as a guide.

Attach 11B and 11C together. Next, fit it over the bracket complex and attach it to the main part.

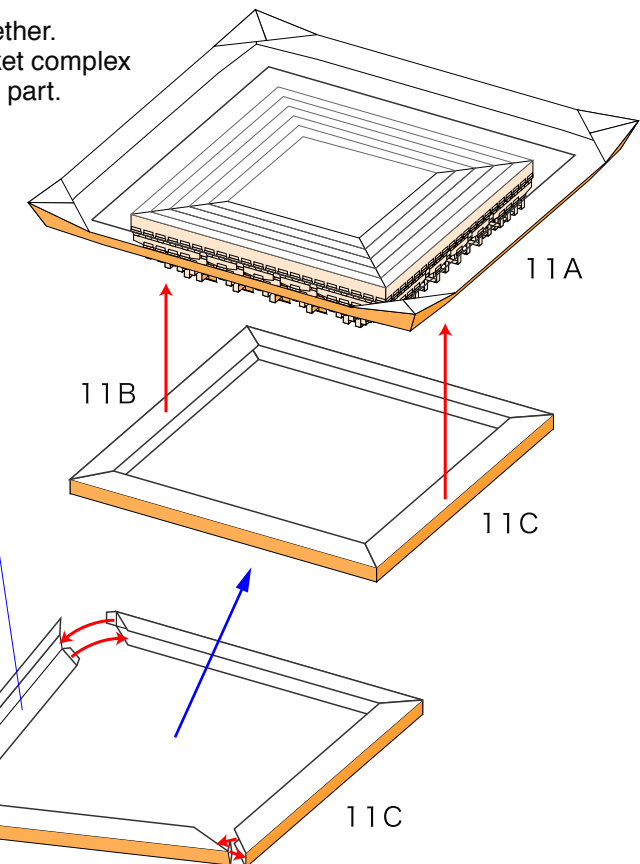

Assemble the curved ridges

Use the 14th and 15th page of the parts sheets.

Fold 14B, 14C along the fold lines, pull them into shape and glue to one side of 14A.

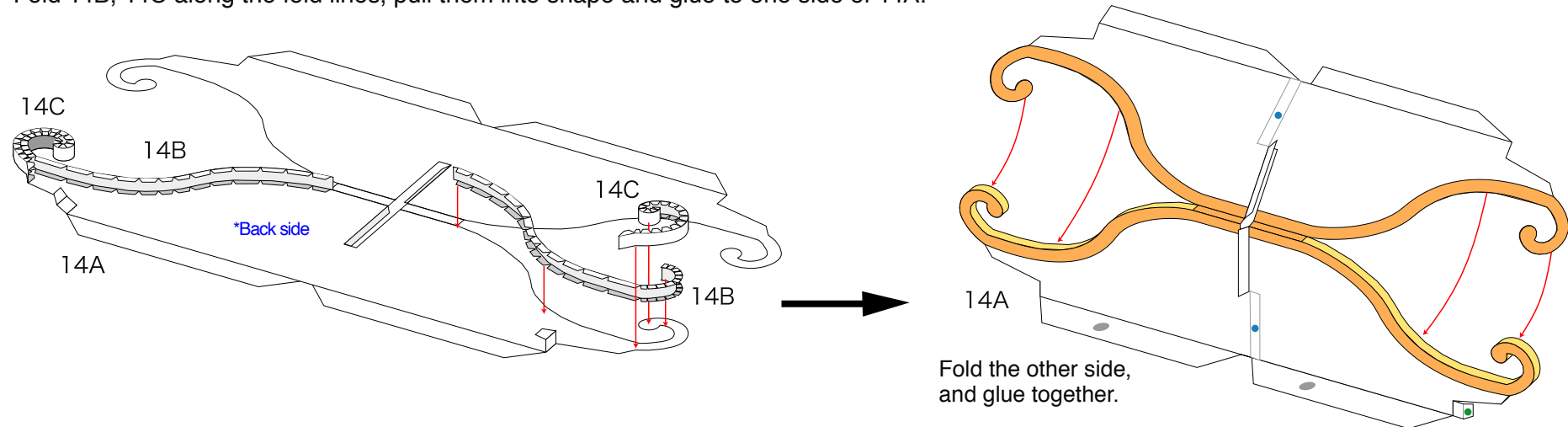

Fold 15B, 15C along the fold lines, pull them into shape and glue to one side of 15A.

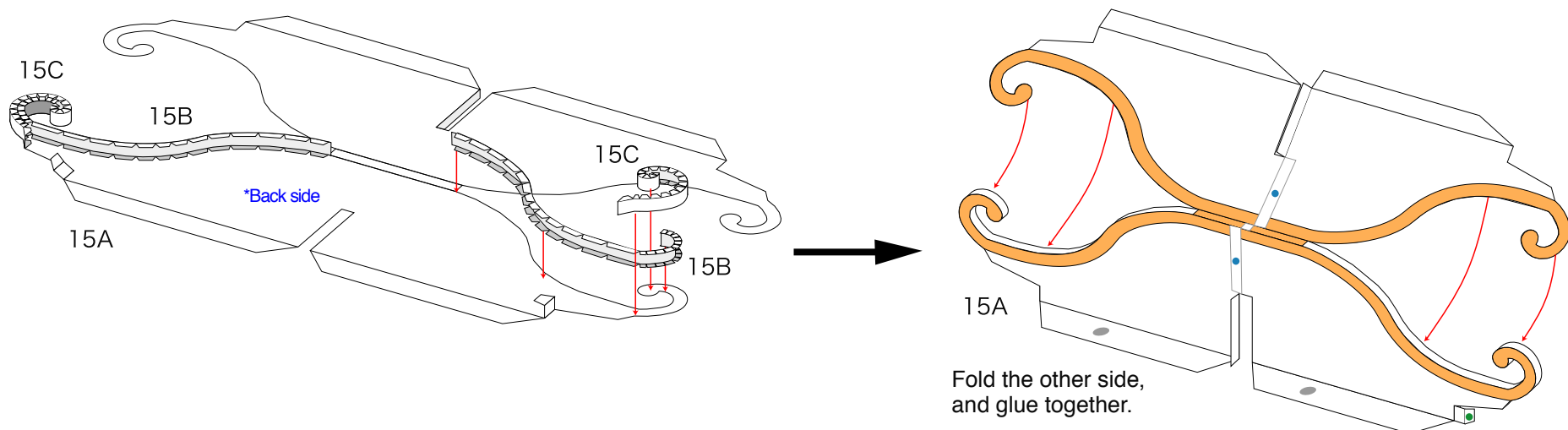

Assemble the curved ridges

Use the 14th and 15th page of the parts sheets.

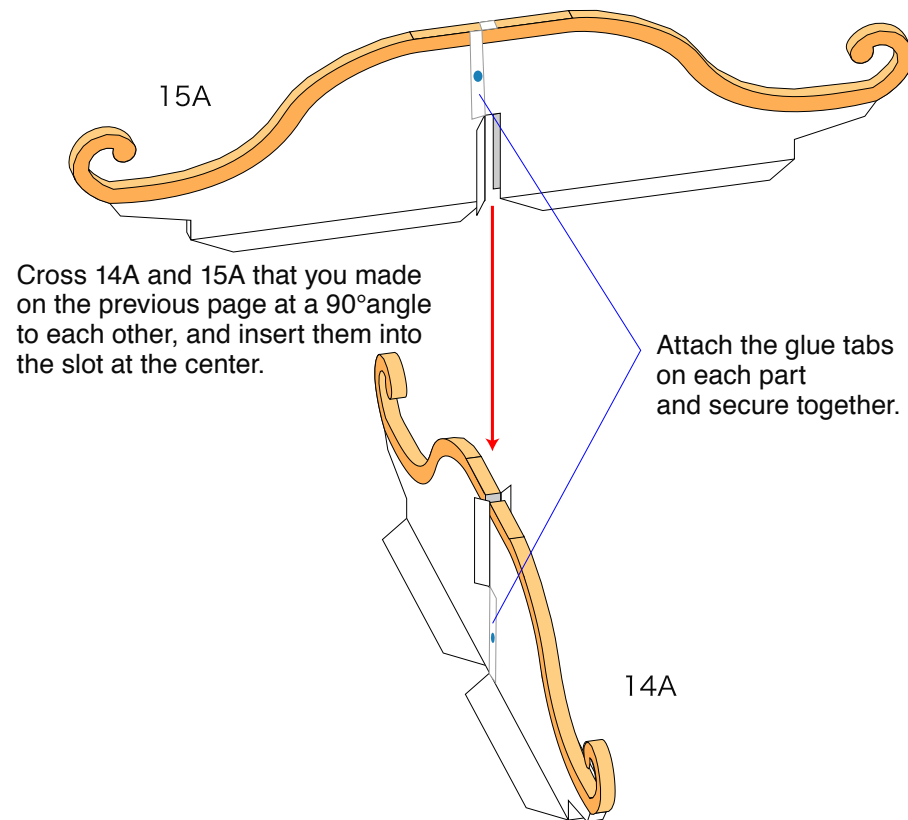

Assemble the roof crest and roof

Use the 12th, 14th and 15th page of the parts sheets.

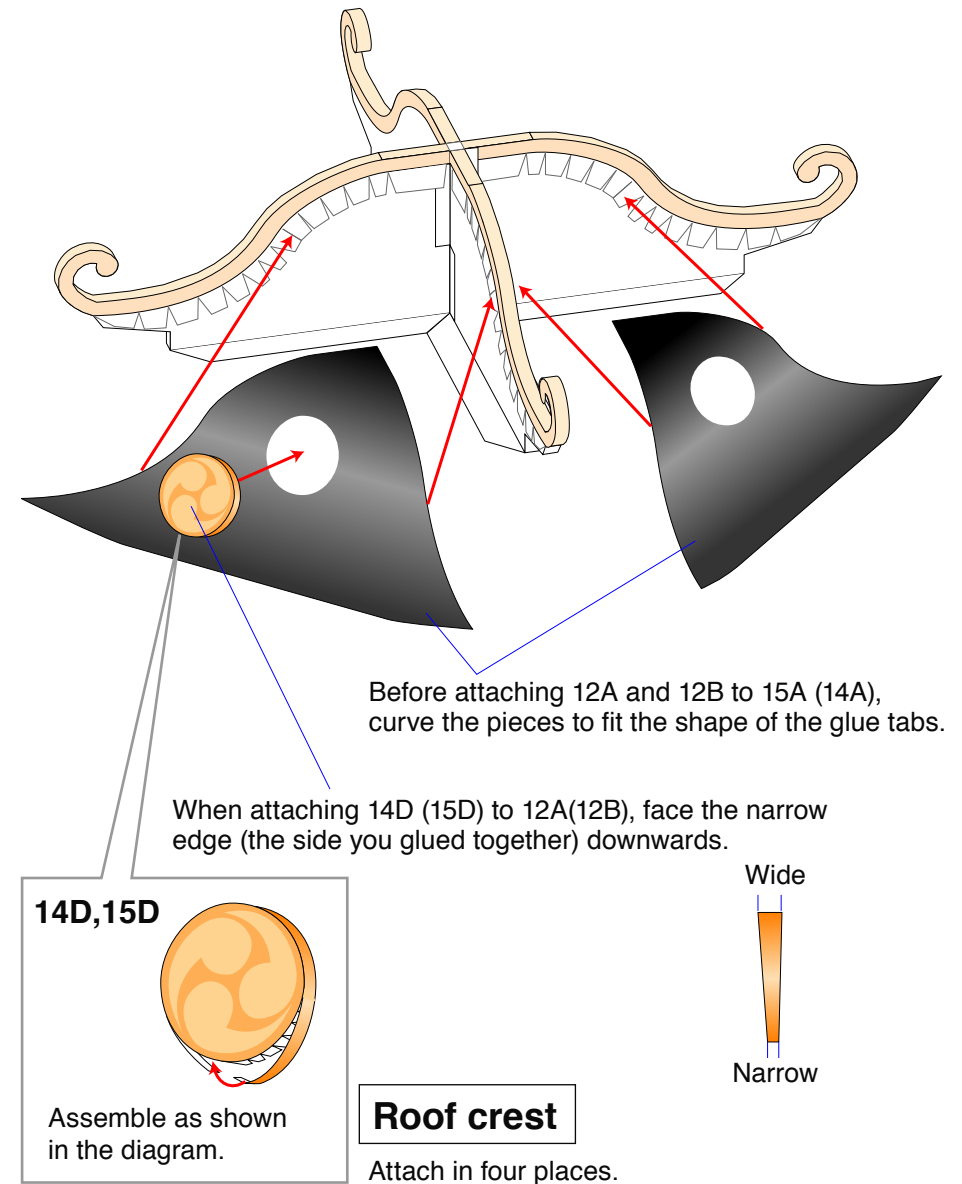

Assemble the protruding cornice decorations

Use the 13th page of the parts sheets.

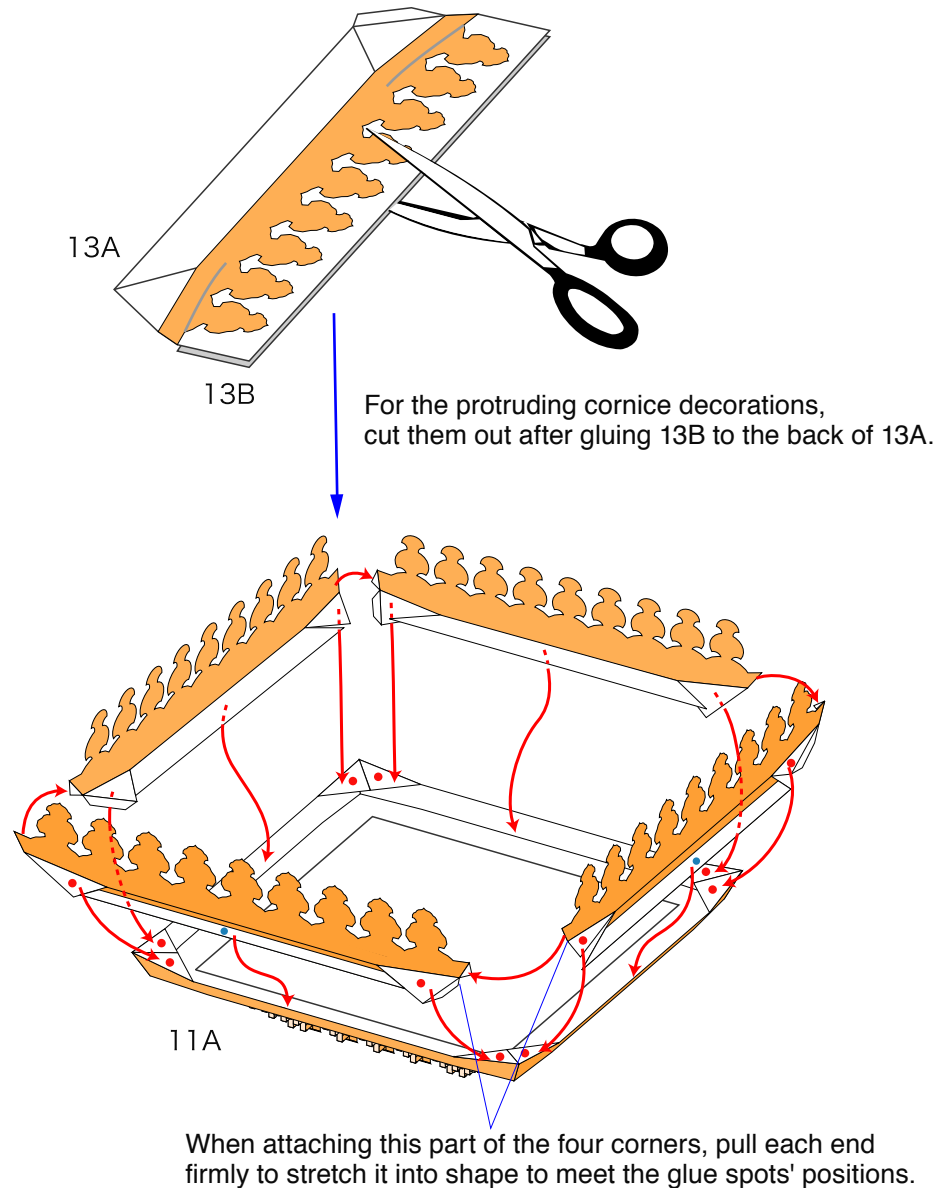

Assemble the phoenix perch and roof

Use the 13th and 15th page of the parts sheets.

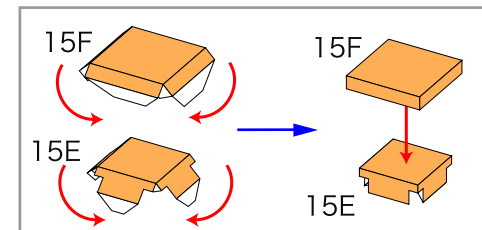

Attach to the roof.

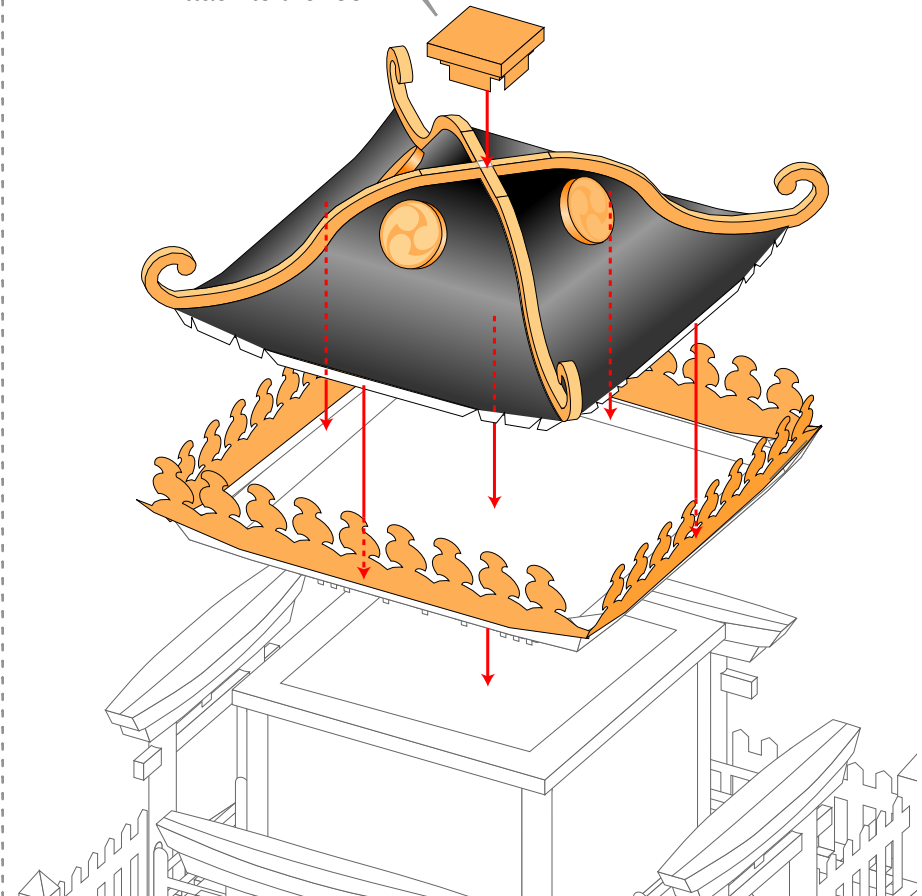

Assemble the decorative string

Use the 17th and 18th page of the parts sheets.

Fold along the fold lines on 17A, 18A and 18B, glue them together and cut out the parts.

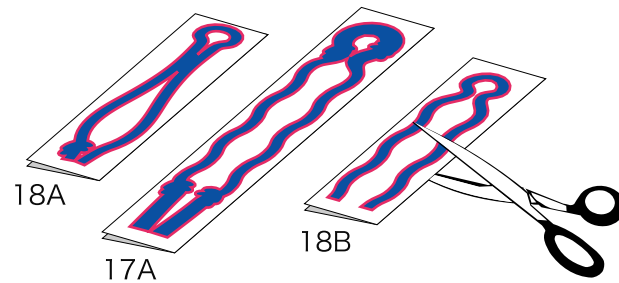

Assemble the 18B.

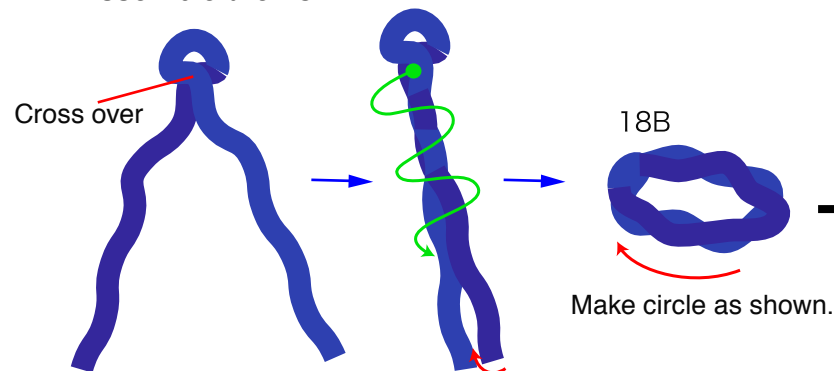

Cross over the curved sections as shown in the diagram, winding the pieces together like a rope.

Assemble as shown.

Make four sets.

*For 17A, do the winding after hooking it onto the roof ornamentation.

Attach 18A to 17A.

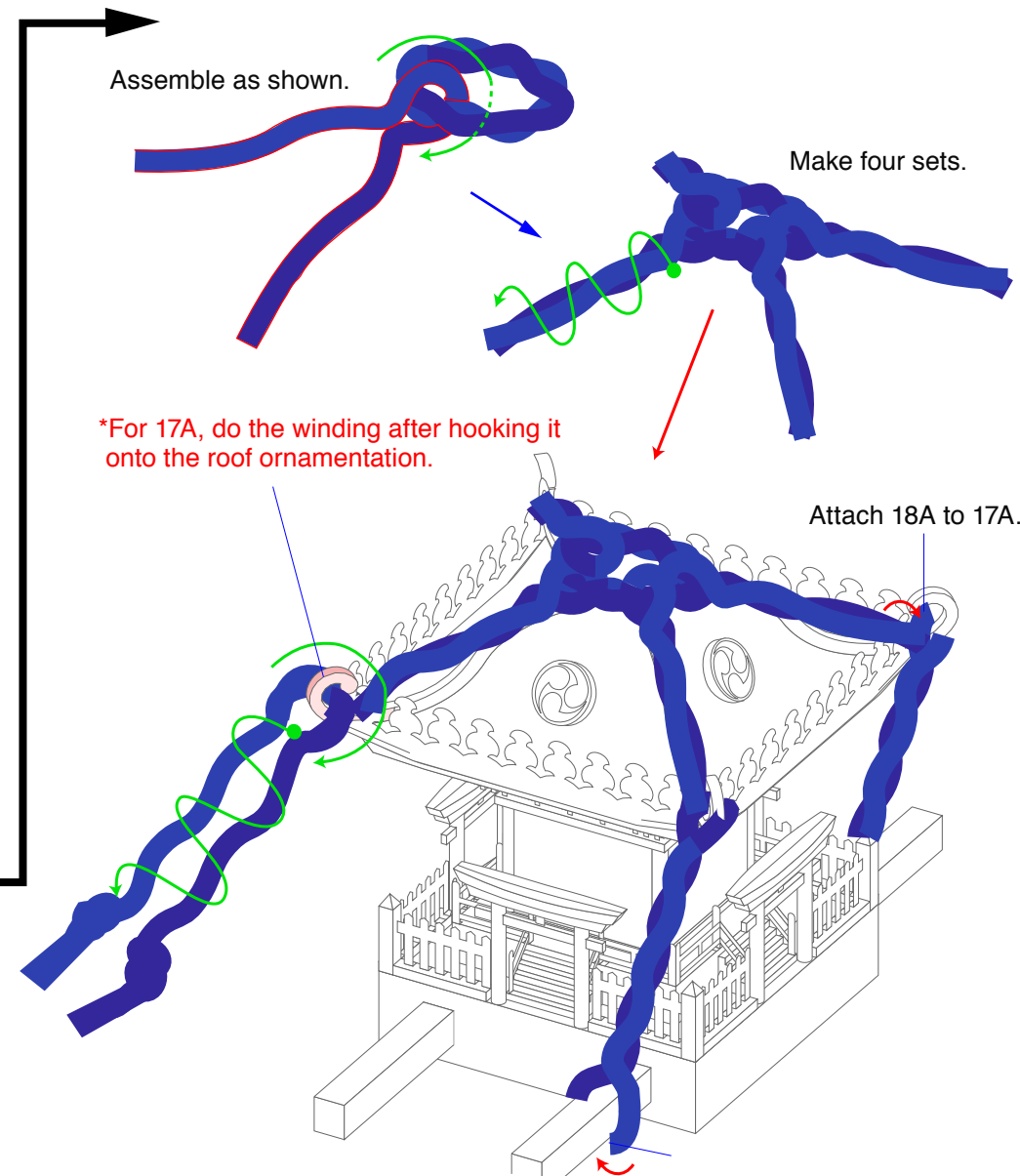

Attach the wound strings' glue tabs together, and secure them to the mikoshi as appropriate.

Assemble the phoenix and small birds

Use the 16th page of the parts sheets.

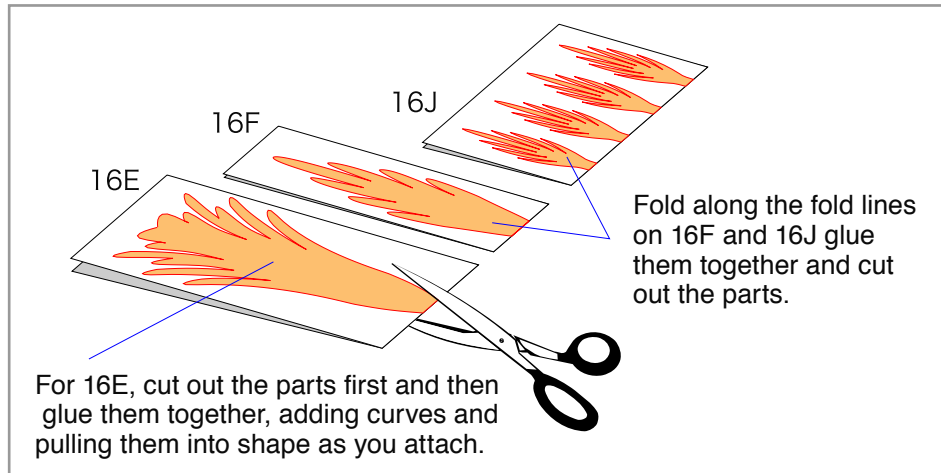

Attach them to the perch and roof ornaments as shown.

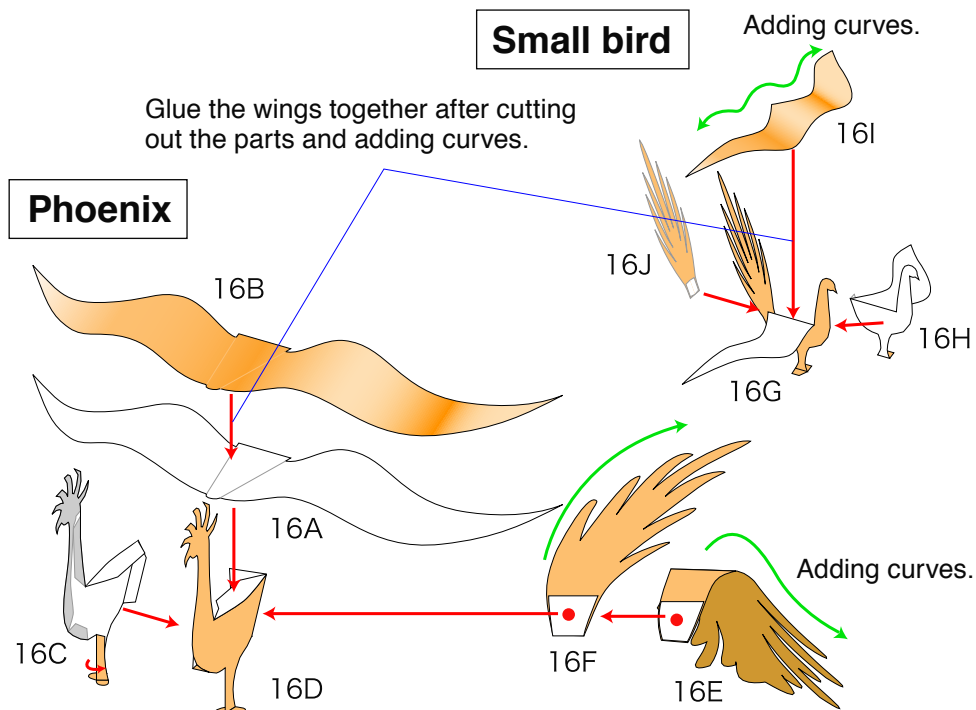
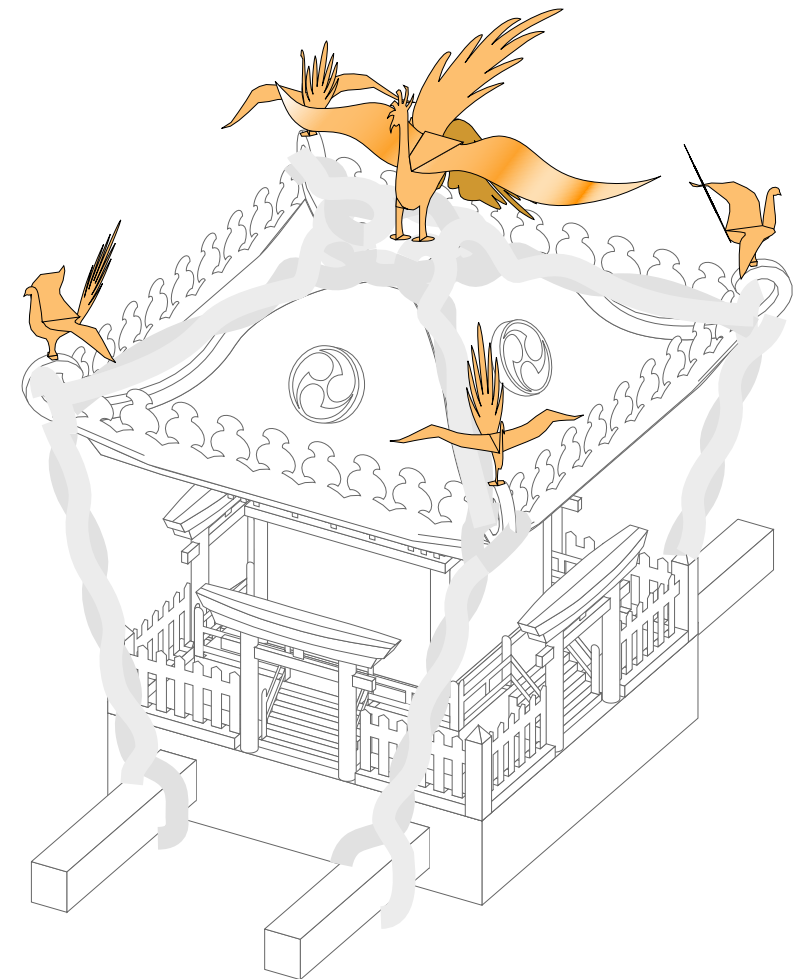

Complete

